

M1 Full Set Model  
 1/2" = 1'0"  
 Build 1

PLATE NOTES

1)

GENERAL NOTES

1)

SUBMITTALS

#	DESCRIPTION	DATE
1	Initial Set Model	01/11/2019
2	Final Set Model	01/20/2019
3		
4		
5		

**Queen**

Because I Am Your Queen

Illinois Theatre

Studio Theatre

Scenic Designer  
 Eleni Lukaszyk  
 Technical Director  
 Naomie S. Winch  
 Assistant Technical Director  
 —  
 Master Carpenter  
 —

Full Set Model

SCALE 1/2" = 1'0" DRAWN BY NSMW

BUILT/SIGNED OFF BY

BIAYQ FULL SET  
 SET-0

ISOMETRIC VIEW

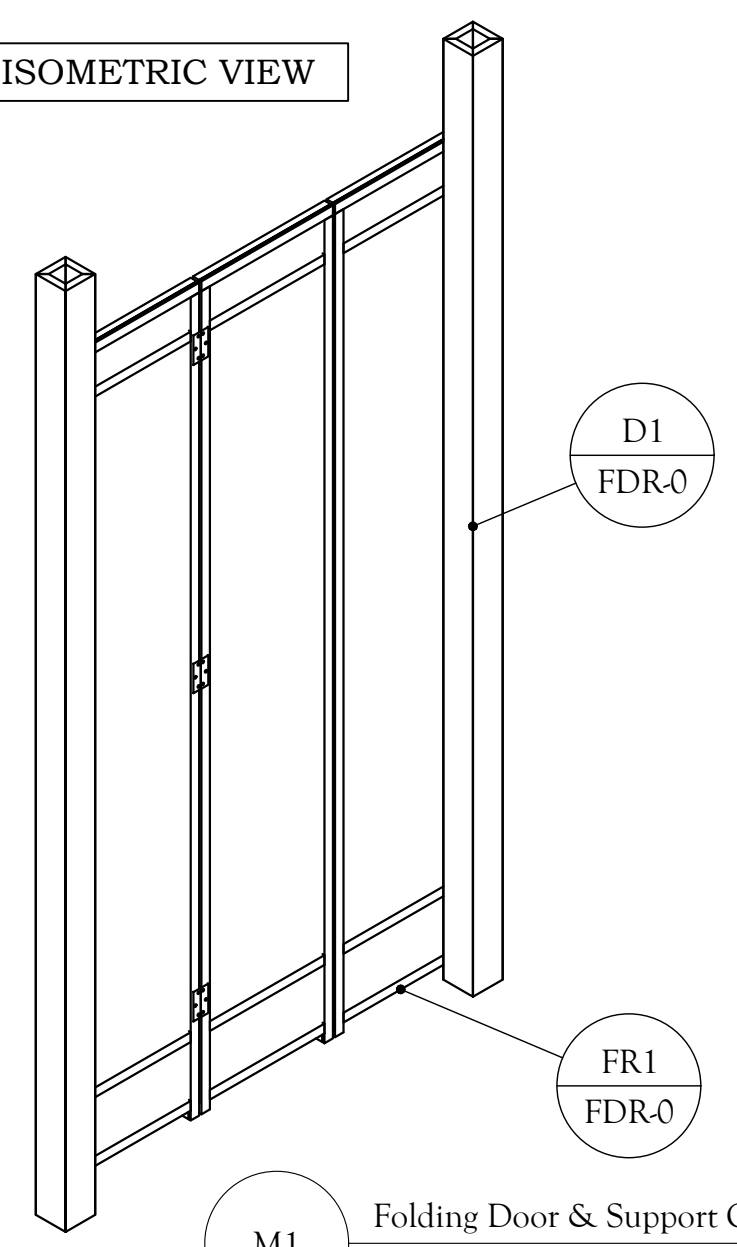

D1  
FDR-0

FR1  
FDR-0

M1 Folding Door & Support Composite  
3/4" = 1'0"

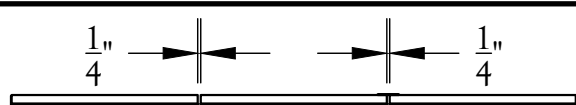

TOP VIEW

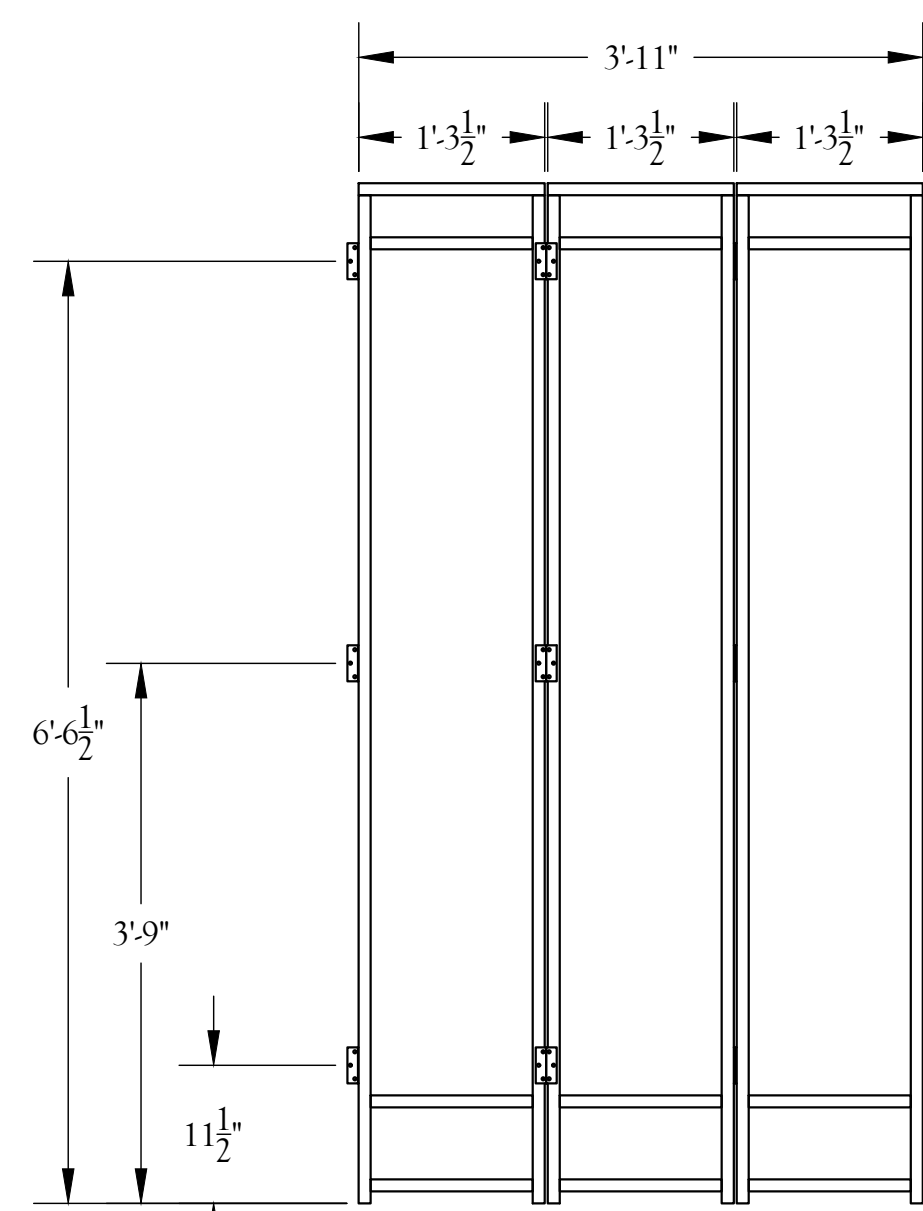

FRONT VIEW

D2 Folding Door Hinge Placement  
1 1/2" = 1'0" R&R 1

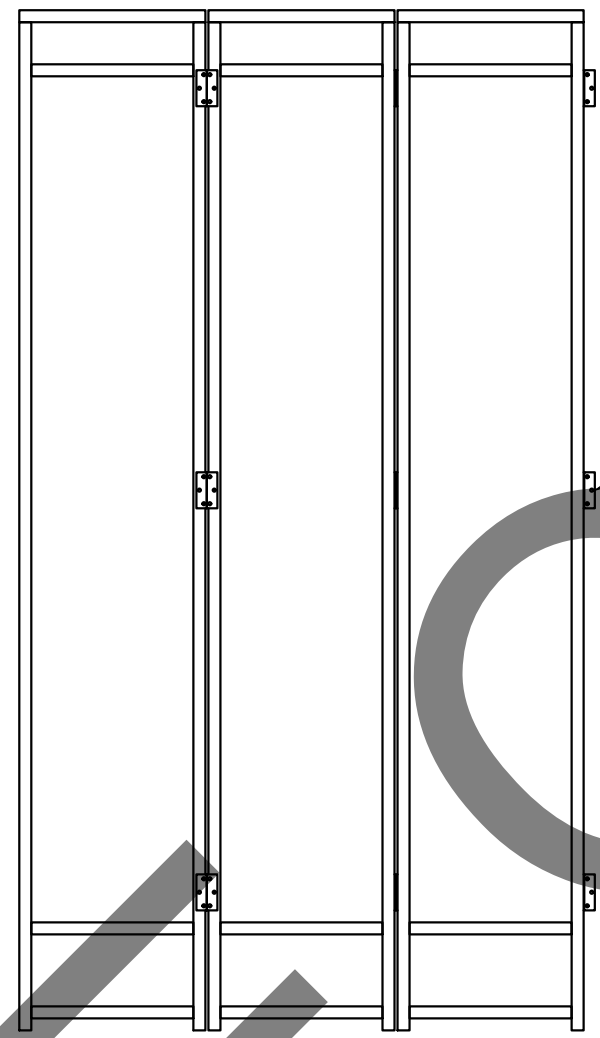

BACK VIEW

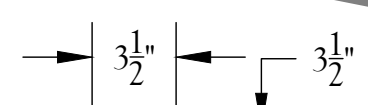

TOP VIEW

FRONT VIEW

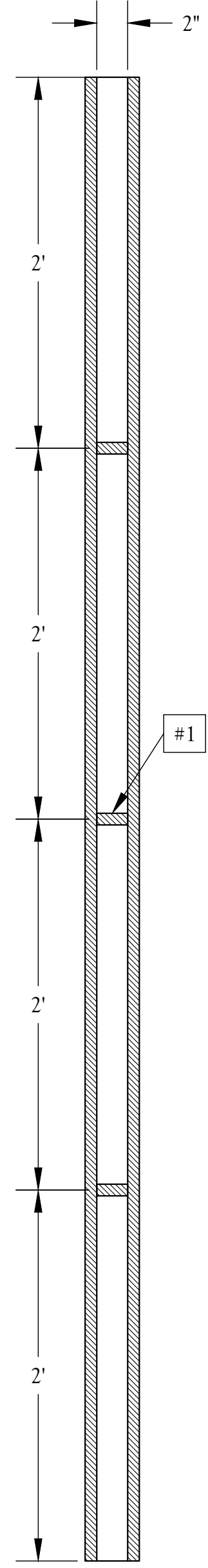

SECTION A-A  
SCALE 1-1/2" = 1'0"

PLATE NOTES

- 1) MATERIAL: 3/4" plywood
- 2) MATERIAL: 1/4" masonite
- 3) MATERIAL: NFR Muslin
- 4) Use hinges from stock. See TD for type.
- 5) Use pocket screws for framing attachment.
- 6) Staple and glue 1/4" masonite to muslin after it is stapled onto 3/4" ply frame.

GENERAL NOTES

- 1) For construction, begin with the 3/4" plywood frame in a jig. Once the back frame is complete, attach muslin then sandwich the muslin edge with the 1/4" masonite front framing.

SUBMITTALS

#	DESCRIPTION	DATE
1	Initial Drawings	01/05/2019
2	Shop Drawings	01/20/2019
3		
4		
5		

Queen

Because I Am Your Queen

Illinois Theatre

Studio Theatre

Scenic Designer  
Eleni Lukaszcyk  
Technical Director  
Naomie S. Winch  
Assistant Technical Director  
—  
Master Carpenter  
—

Folding Doors & Supports

SCALE Varies = 1'0" DRAWN BY NSMW

BUILT/SIGNED OFF BY

FOLD DOOR  
FDR-0

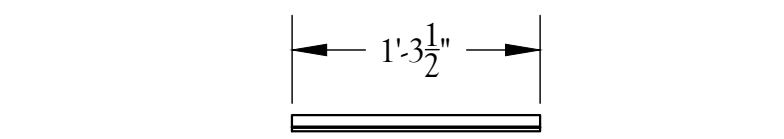

TOP VIEW

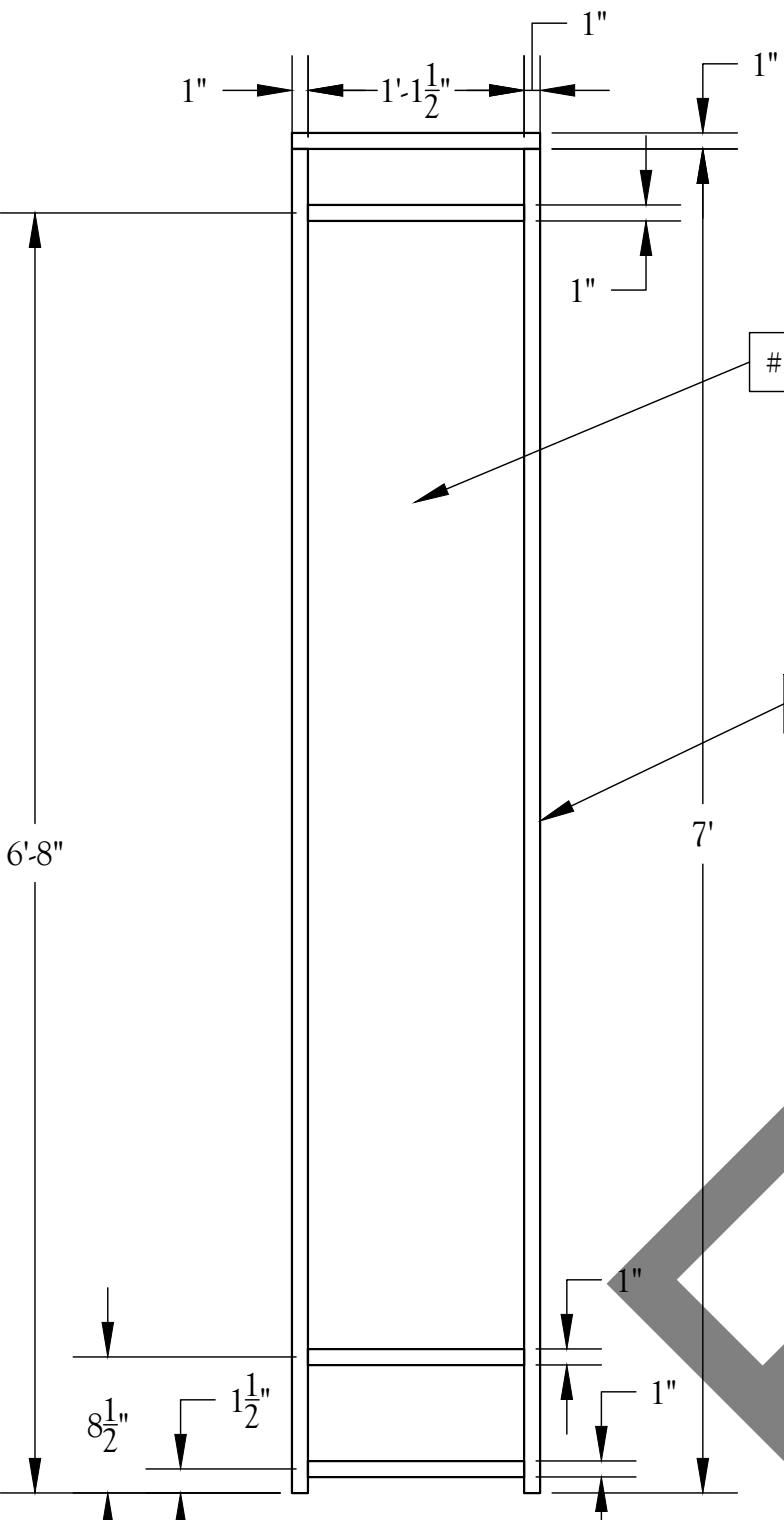

FRONT VIEW

FR1 Individual Folding Door  
1" = 1'0" Build 6

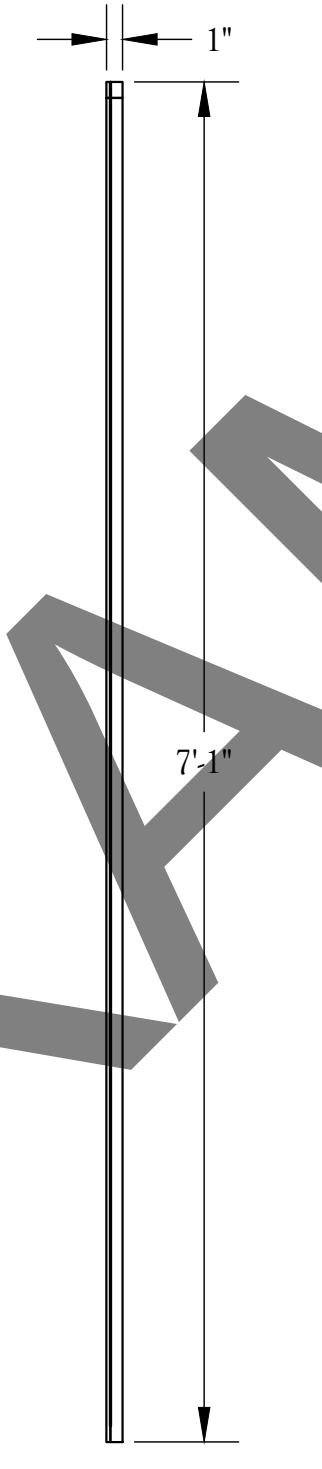

SIDE VIEW

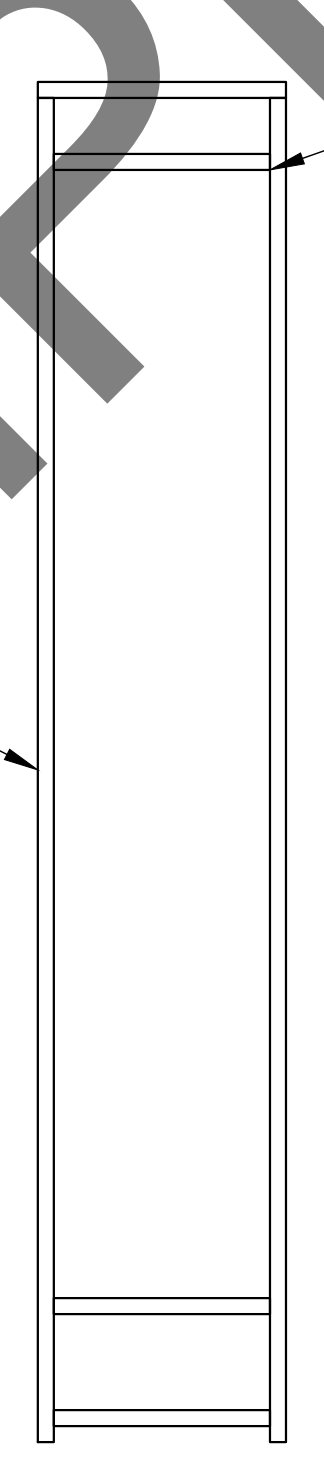

BACK VIEW

D1 Column Support  
1 1/2" = 1'0" Build 4

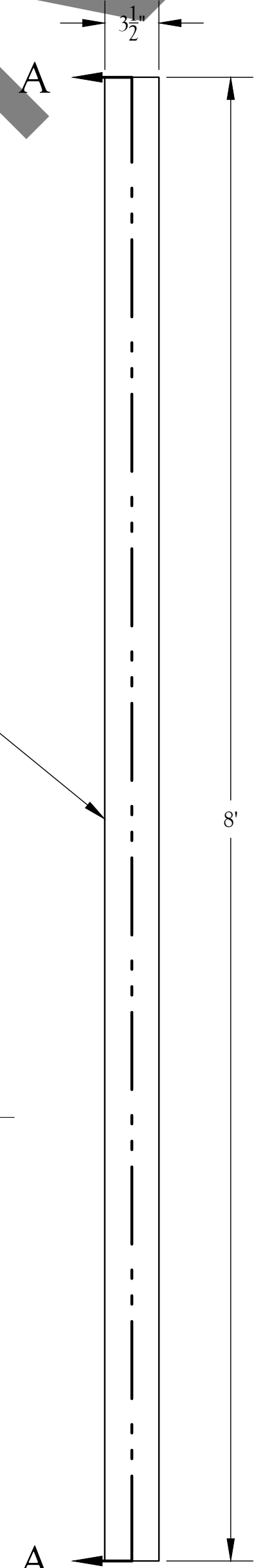

FRONT VIEW

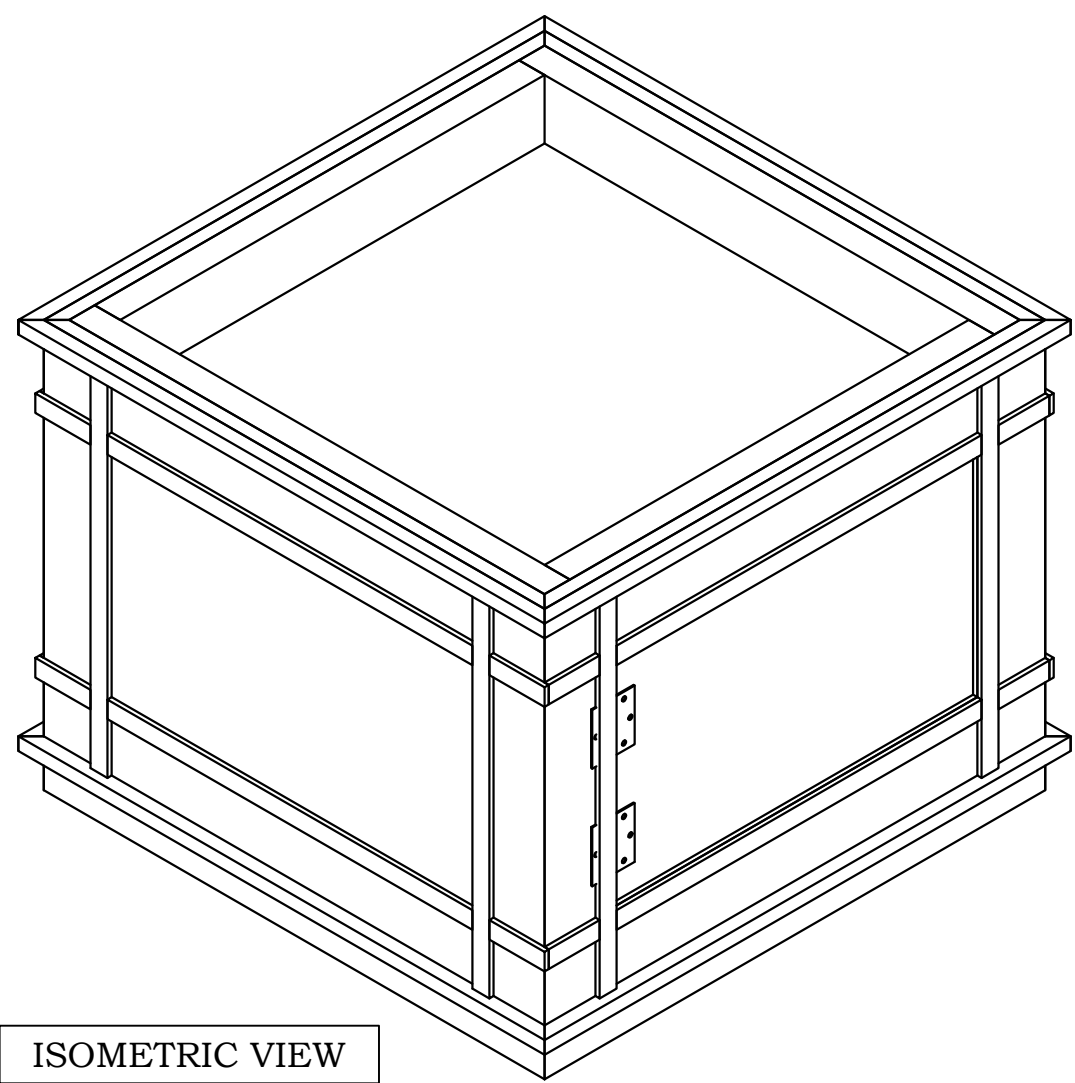

ISOMETRIC VIEW

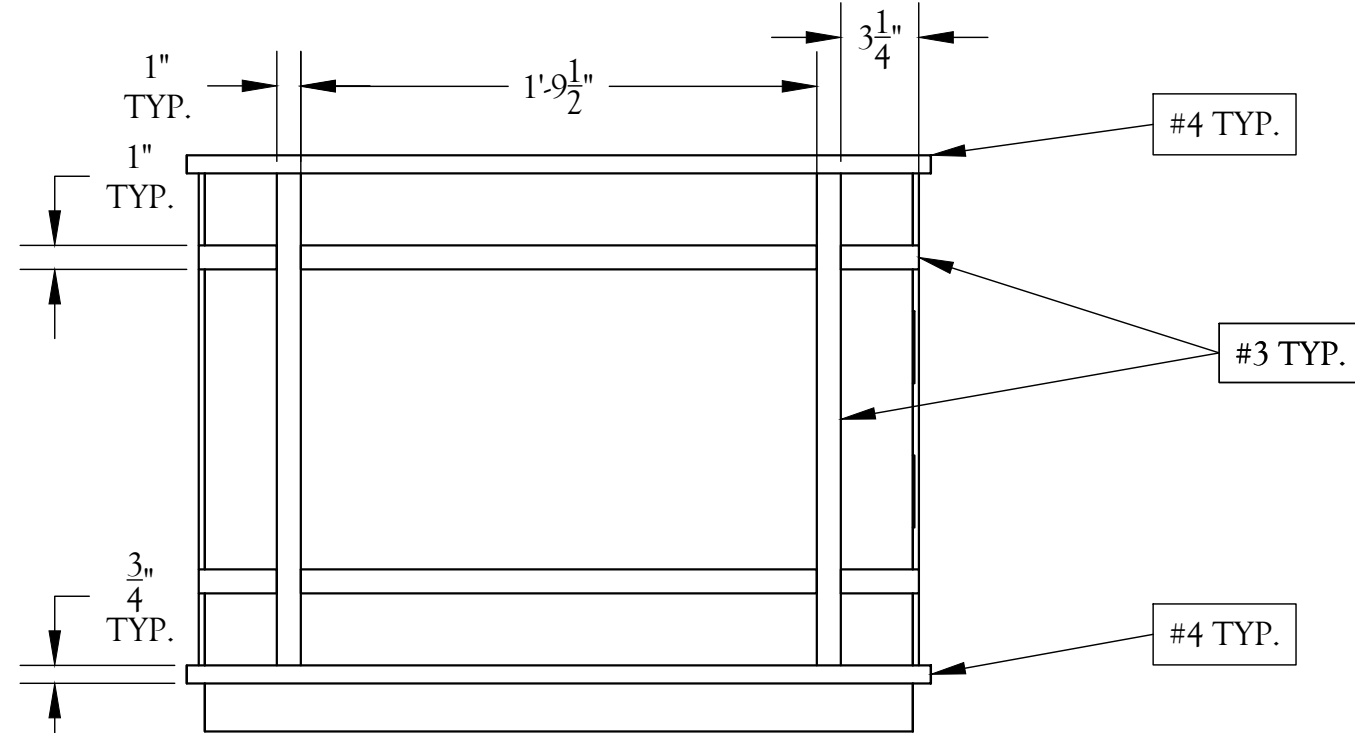

SIDE VIEW

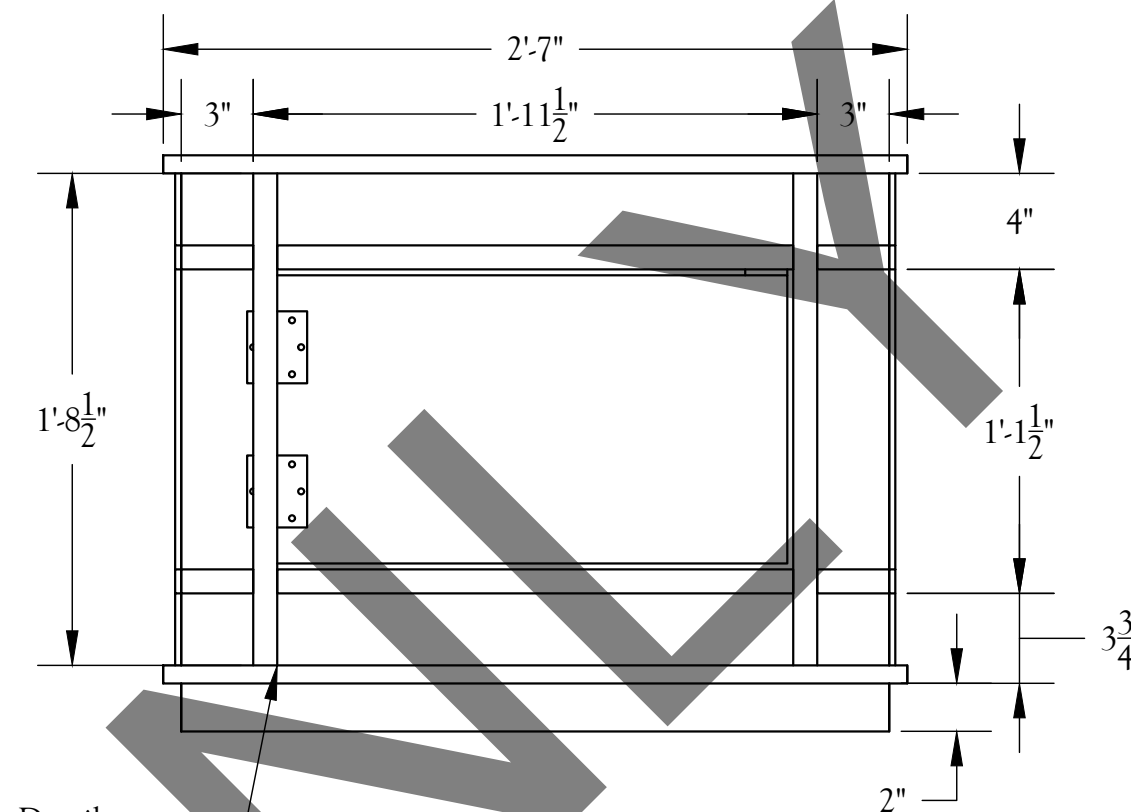

FRONT VIEW

MO1 Mini Planter Moulding Detail  
1 1/2" = 1'0"

M1 Mini Planter Composite  
1 1/2" = 1'0"

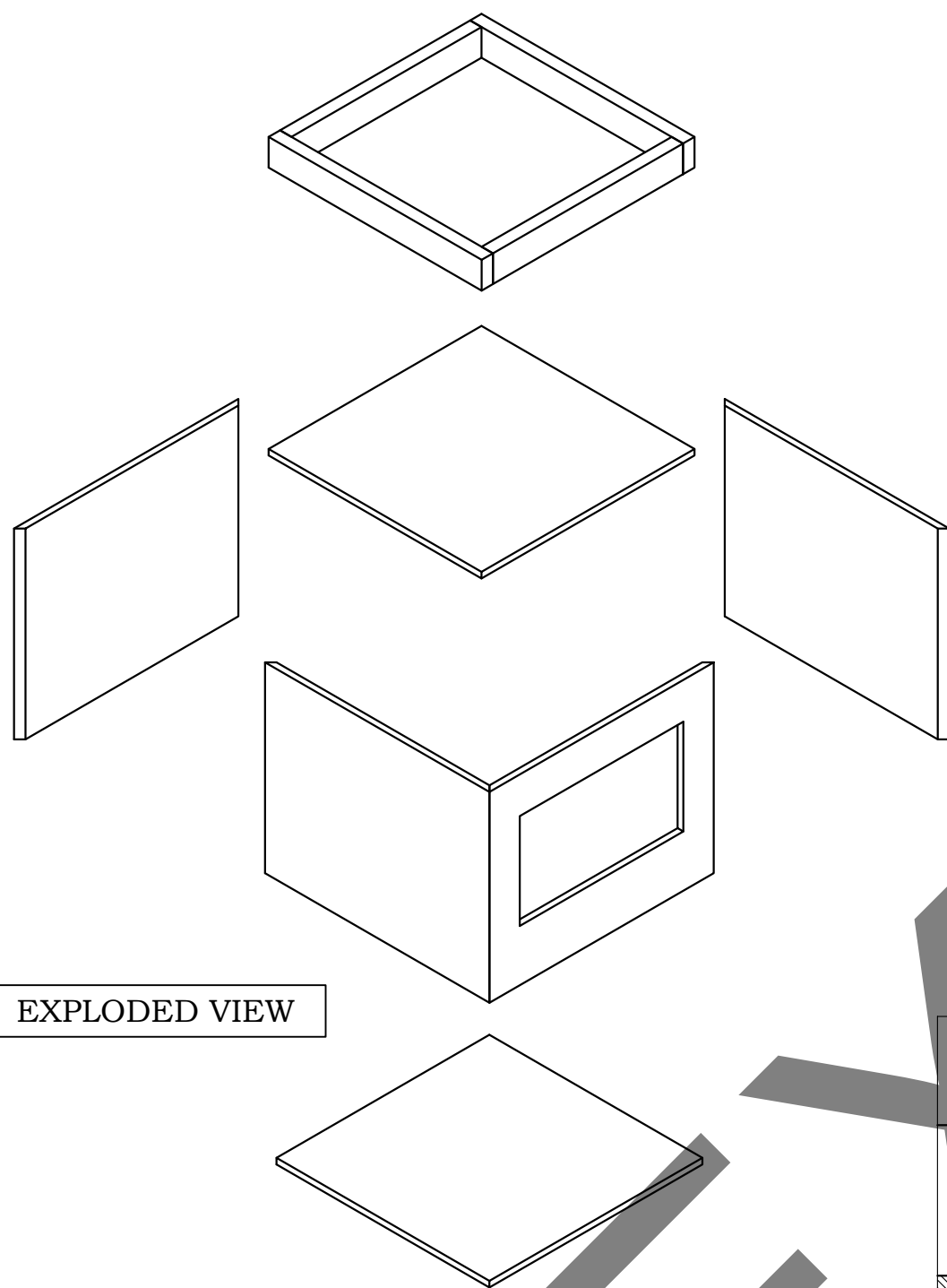

EXPLODED VIEW

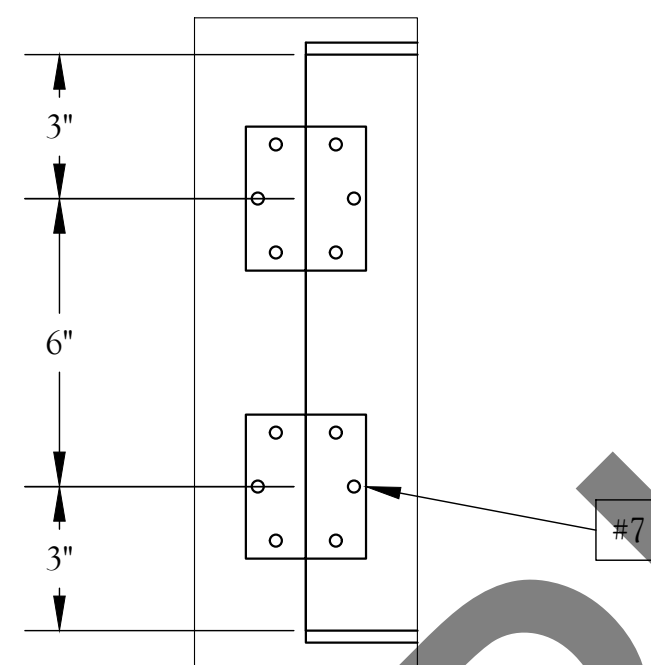

DETAIL C  
SCALE 3" = 1'0"

SK1 Mini Planter Frame/Skin  
1 1/2" = 1'0" Build 2

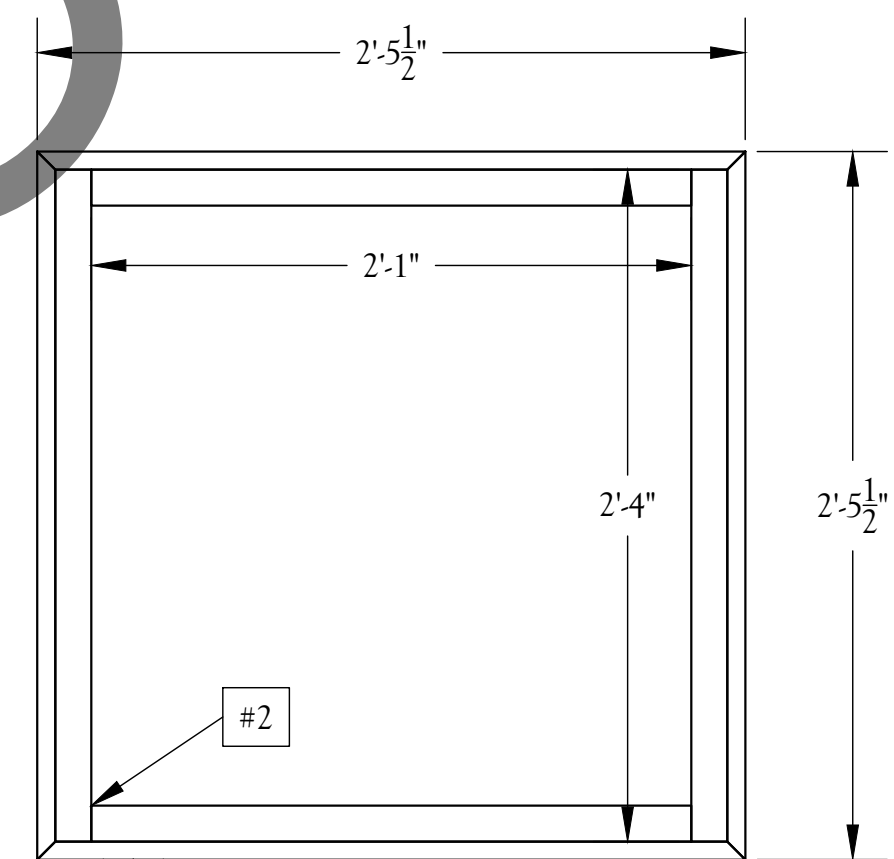

TOP VIEW

#1 & #5

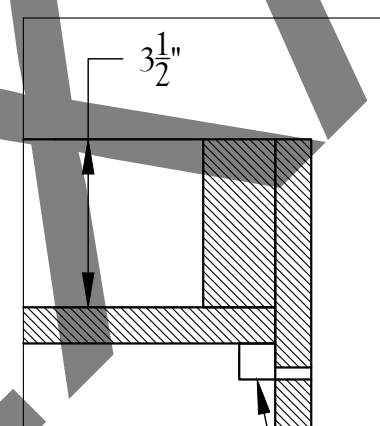

DETAIL B  
SCALE 3" = 1'0" #6

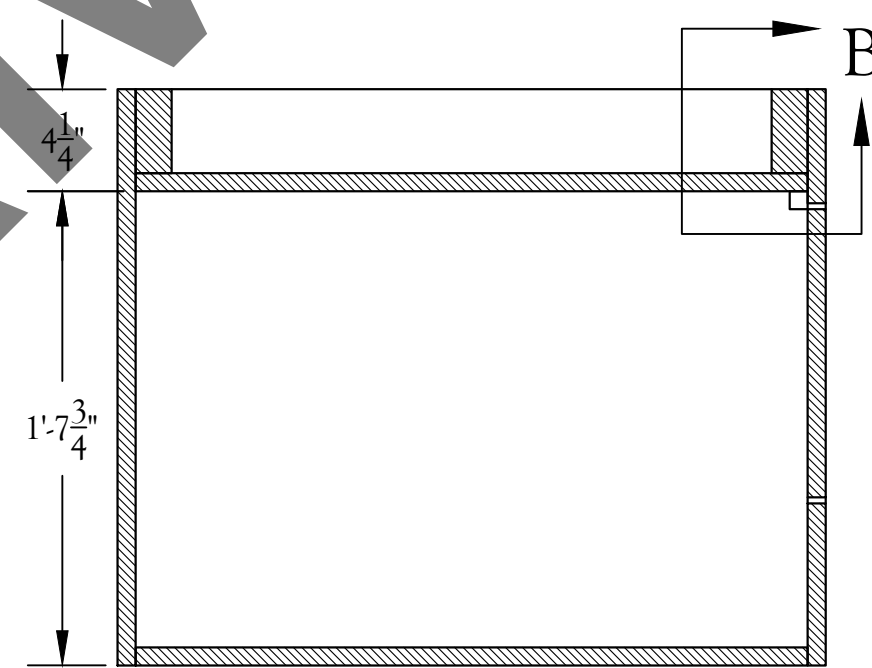

SECTION A-A  
SCALE 1-1/2" = 1'0"

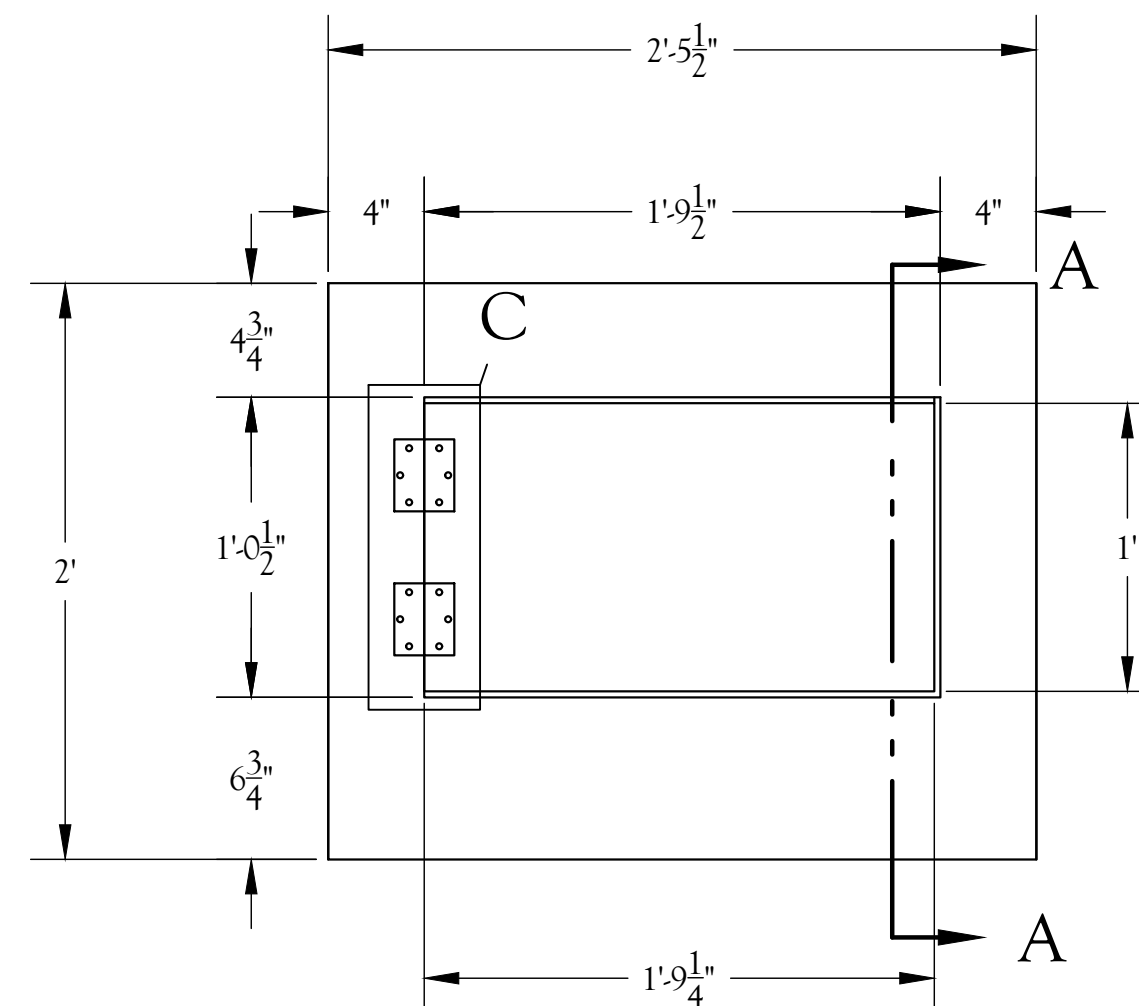

FRONT VIEW

PLATE NOTES

- 1) MATERIAL: 3/4" plywood
- 2) MATERIAL: 2"x4" nominal lumber on edge.
- 3) MATERIAL: 1/4" masonite; non mitered corners
- 4) MATERIAL: 3/4" MDF; mitered (45 degree) corners
- 5) Note the mitered (45 degree) corners.
- 6) Tiny block of 3/4" plywood for magnet catch to attach to.
- 7) Use standard hinges. See TD for questions.
- 8) For this piece of moulding that goes over the hinges, please dado for hinge.

GENERAL NOTES

- 1) All moulding placement measurements are from the edge of the box, not the moulding. It is all mirrored to the opposite side (important for the non mitered corners).
- 2) Build 2

SUBMITTALS

#	DESCRIPTION	DATE
1	Initial Drawings	01/06/2019
2	Shop Drawings	01/20/2019
3		
4		
5		

Queen

Because I Am Your Queen

Illinois Theatre

Studio Theatre

Scenic Designer  
Eleni Lukaszczuk  
Technical Director  
Naomie S. Winch  
Assistant Technical Director  
—  
Master Carpenter  
—

Mini Planters

SCALE Varies = 1'0" DRAWN BY NSMW

BUILT/SIGNED OFF BY

MINI PLANT  
MPL-0

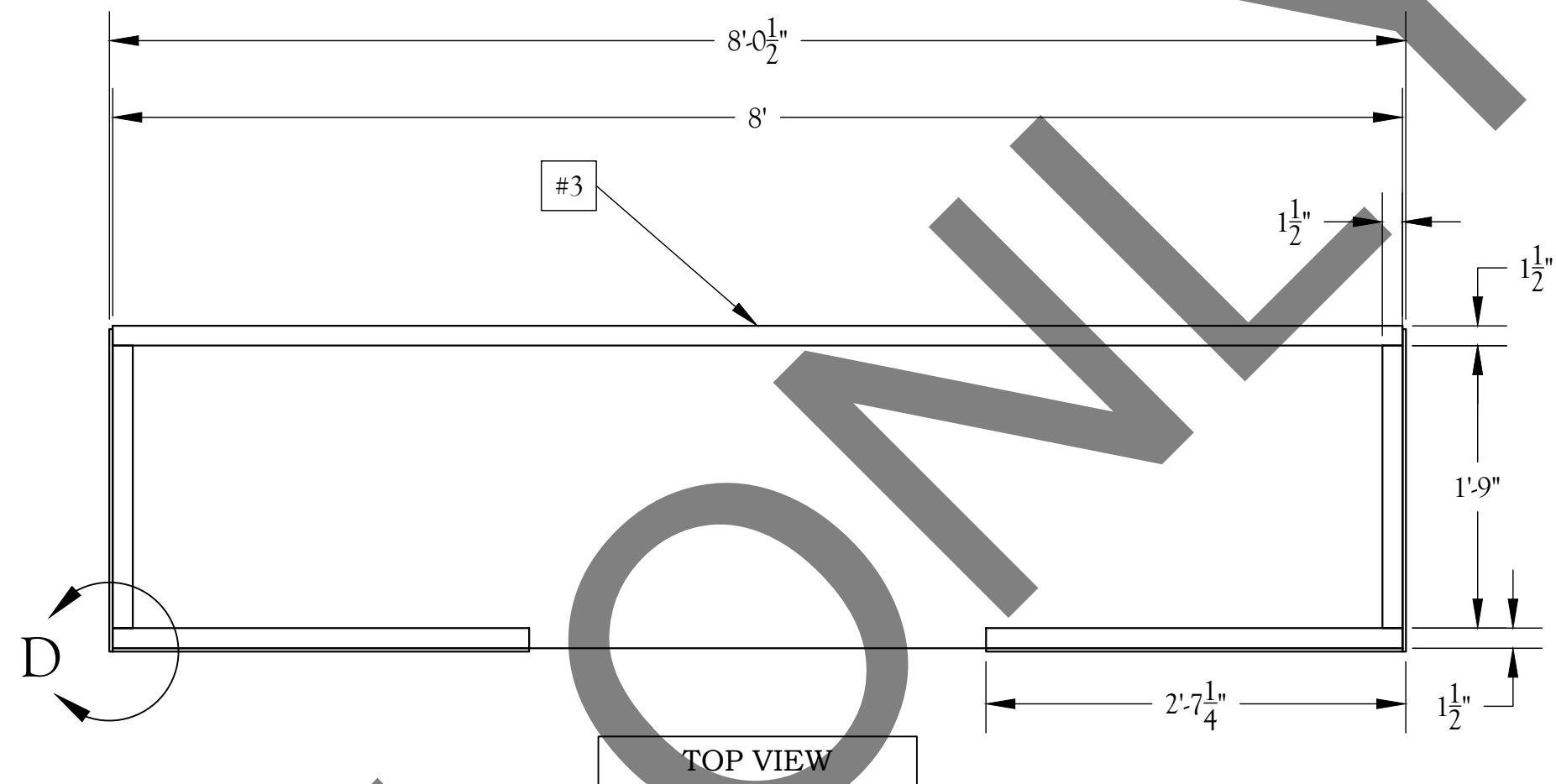
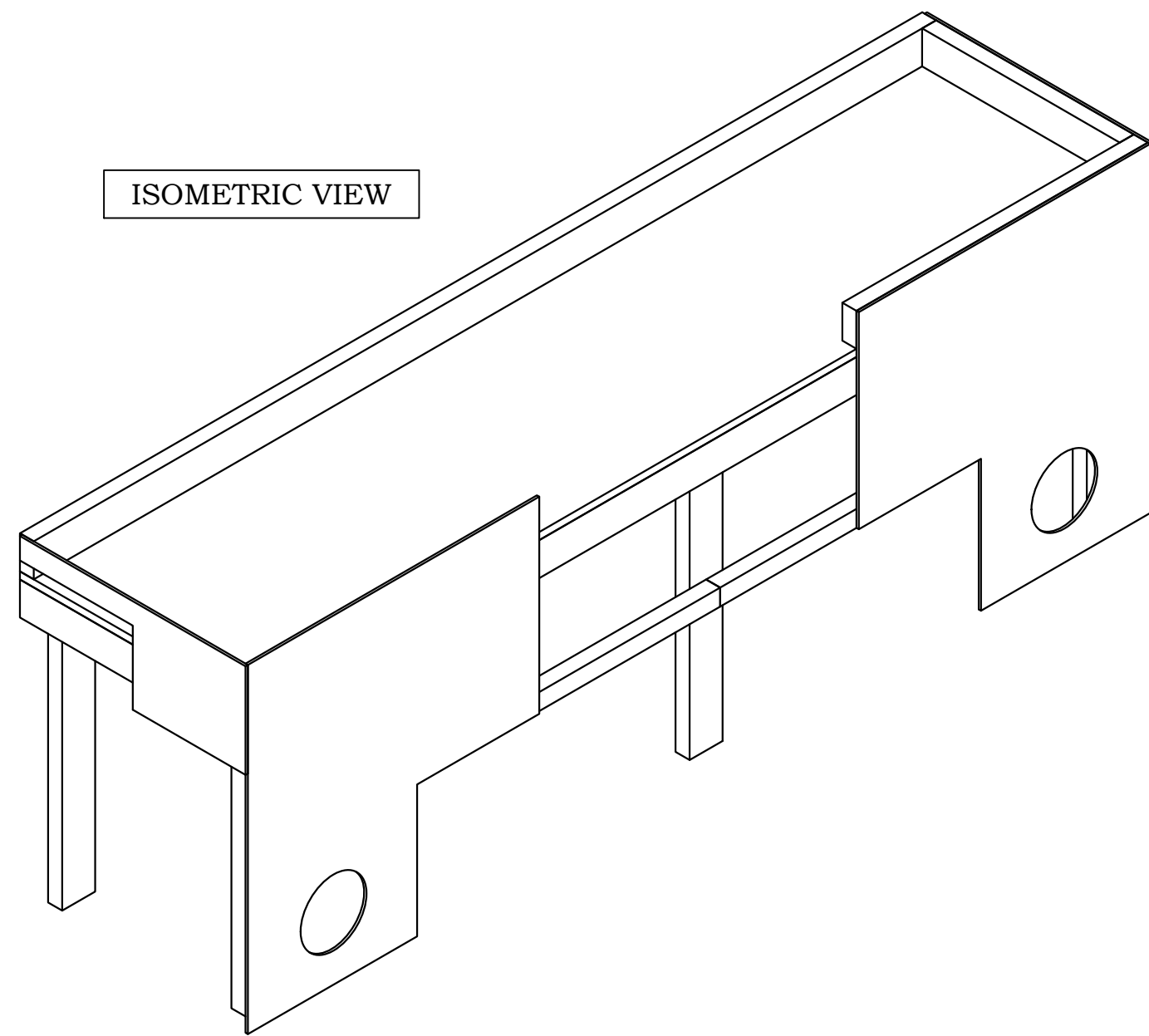

SK1 Large Planter Frame/Skin  
1" = 1'0" Build 1

**PLATE NOTES**

- 1) Facing removed for clarity to see ribbon dimensions.
- 2) MATERIAL: 1/4" masonite
- 3) MATERIAL: 2x4 nominal lumber on edge.
- 4) Side skin caps facing.
- 5) MATERIAL: 2x4 dimensional lumber ripped in half.
- 6) Mirrored on other side of large planter.

**GENERAL NOTES**

1) This planter is a modified 2' x 8' platform with standard OLD style construction. Standard stock legging technique with 29 3/4" legs. Ribbon added for facing attachment.

**SUBMITTALS**

#	DESCRIPTION	DATE
1	Initial Drawings	01/06/2019
2	Shop Drawings	01/20/2019
3		
4		
5		

**Queen**

Because I Am Your Queen

Illinois Theatre

Studio Theatre

Scenic Designer  
Eleni Lukaszczuk  
Technical Director  
Naomie S. Winch  
Assistant Technical Director  
—  
Master Carpenter  
—

Large Planter

SCALE Varies = 1'0" DRAWN BY NSMW

BUILT/SIGNED OFF BY

**LARGE PLANT**  
LPL-0

CNC: BIA YQ-STU-LPL-.25 Maso

CNC: BIA YQ-STU-LPL-.25 Maso

CNC: BIA YQ-STU-LPL-.25 Maso

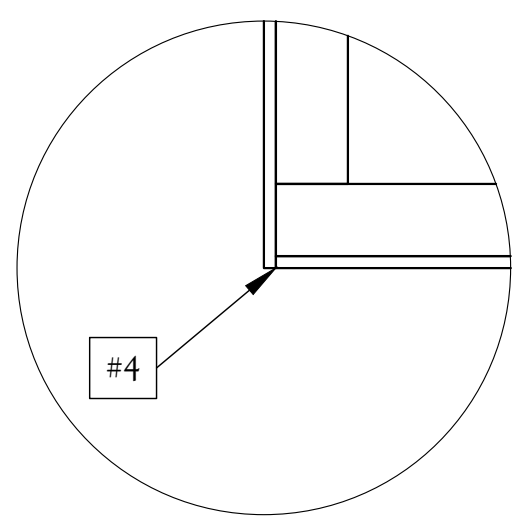
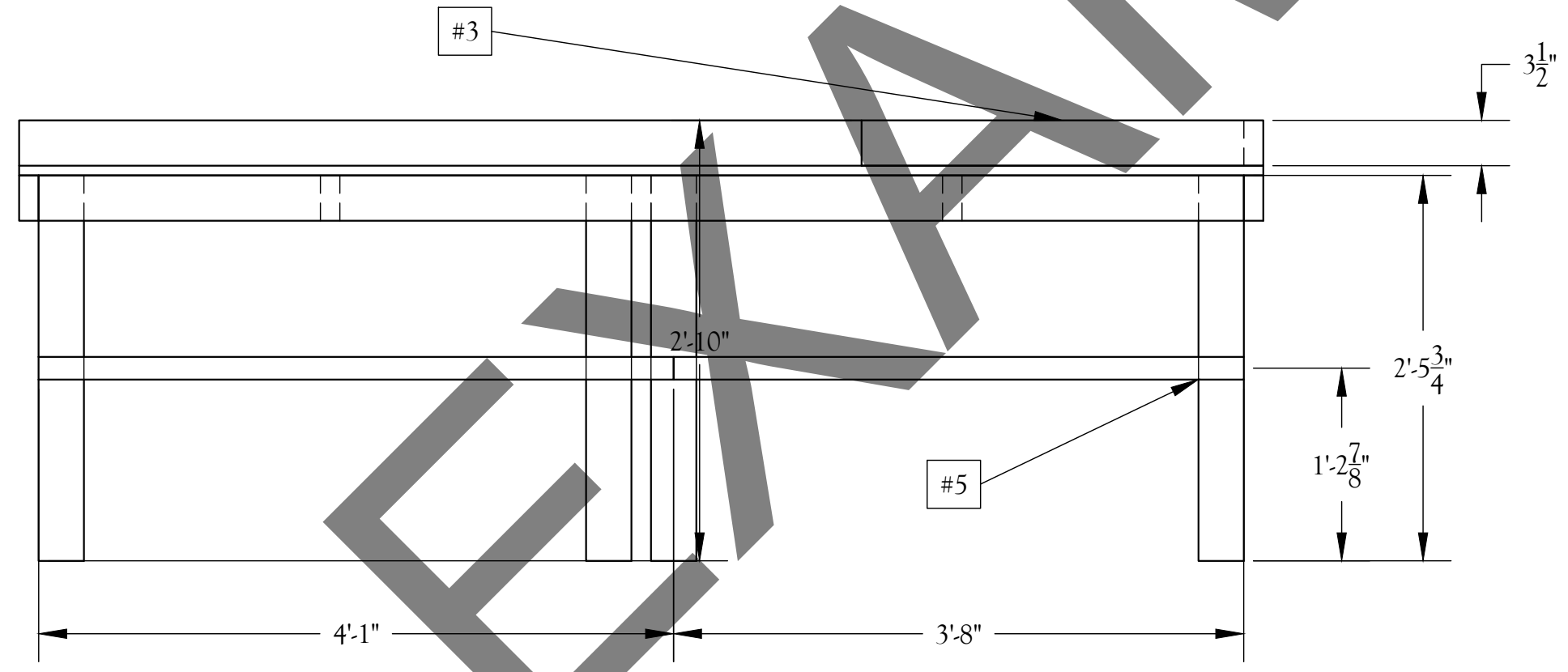

DETAIL D  
SCALE 3" = 1'-0"

PLATE NOTES

1)

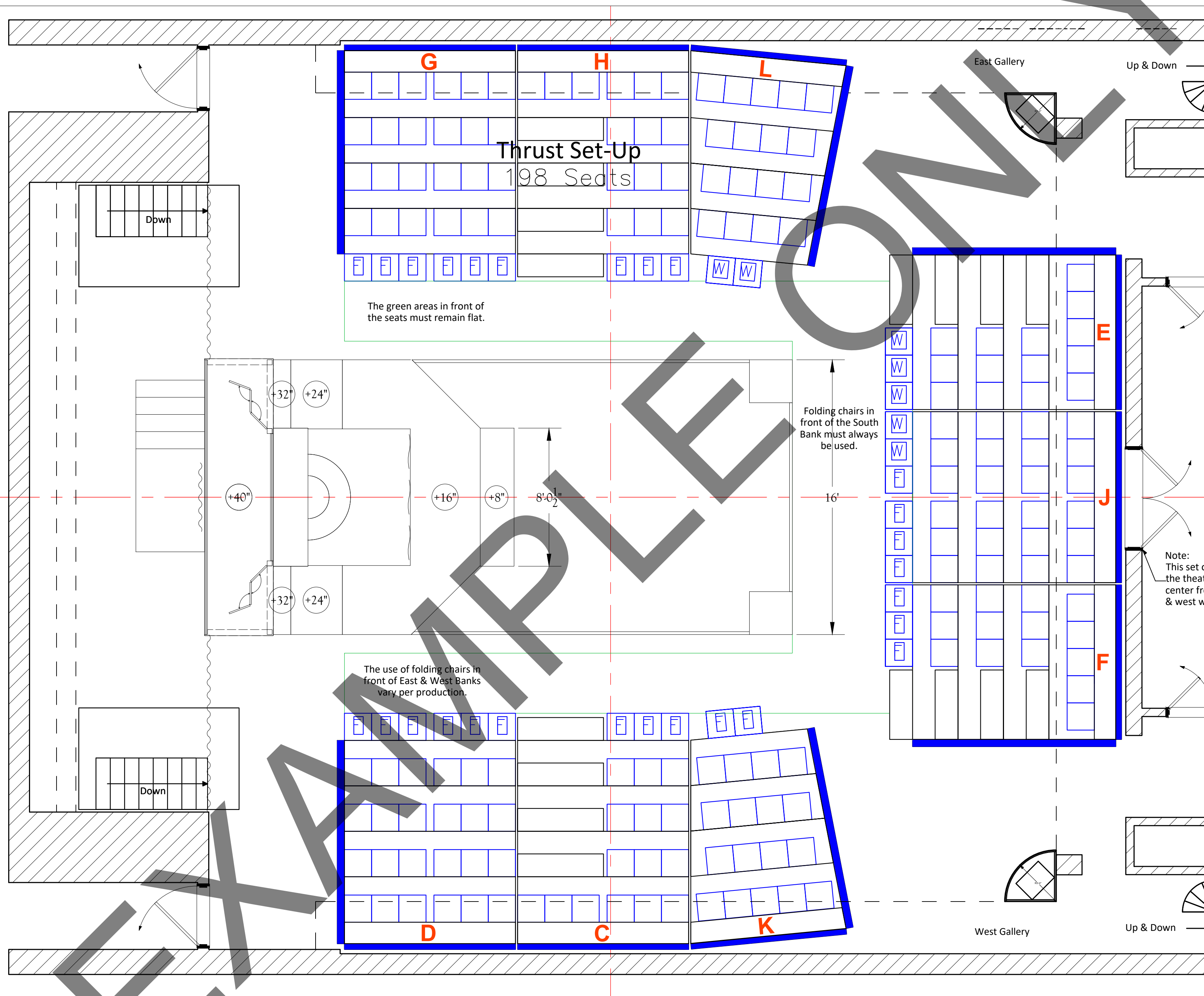
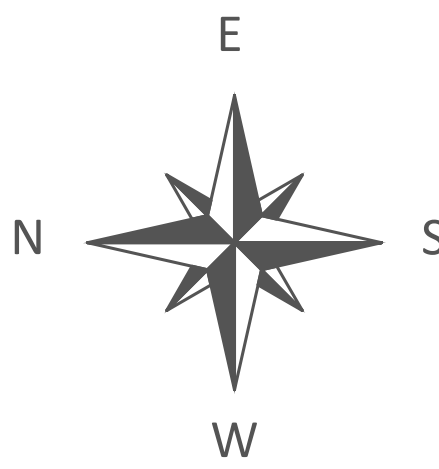

GENERAL NOTES

1) Seating arrangement is standard thrust configuration with no modifications.

SUBMITTALS

#	DESCRIPTION	DATE
1	Rough GP for Seating	11/28/2018
2	Final GP	01/11/2019
3		
4		
5		

Queen

Because I Am Your Queen

Illinois Theatre

Studio Theatre

Scenic Designer  
Eleni Lukaszcyk  
Technical Director  
Naomie S. Winch  
Assistant Technical Director  
—  
Master Carpenter  
—

Rough Groundplan

SCALE 1/4" = 10"  
DRAWN BY NSMW  
BUILT/SIGNED OFF BY

BIAYQ GP  
GP-0

**PLATE NOTES**

- 1) MATERIAL:  $\frac{1}{4}$ " masonite
- 2) SIZE: 7" in diameter; all the way through.
- 3) Cut bottom half first and use horizontal cut off line. Once remainder piece is left, then cut grate top half.
- 4) See note 3; cut with  $\frac{3}{16}$ " or  $\frac{1}{8}$ " bit first. Rerun the same file with a  $\frac{1}{16}$ " bit to clean up corners.

**GENERAL NOTES**

1)

**SUBMITTALS**

#	DESCRIPTION	DATE
1	Shop CNC Layout Files	01/21/2019
2		
3		
4		
5		

**Queen**

Because I Am Your Queen

Illinois Theatre

Studio Theatre

Scenic Designer  
Eleni Lukaszczyk  
Technical Director  
Naomie S. Winch  
Assistant Technical Director  
---  
Master Carpenter  
---

MASO CNC

SCALE  
1" = 1'0"

DRAWN BY  
NSMW

BUILT/SIGNED OFF BY

CNC  
MASONITE

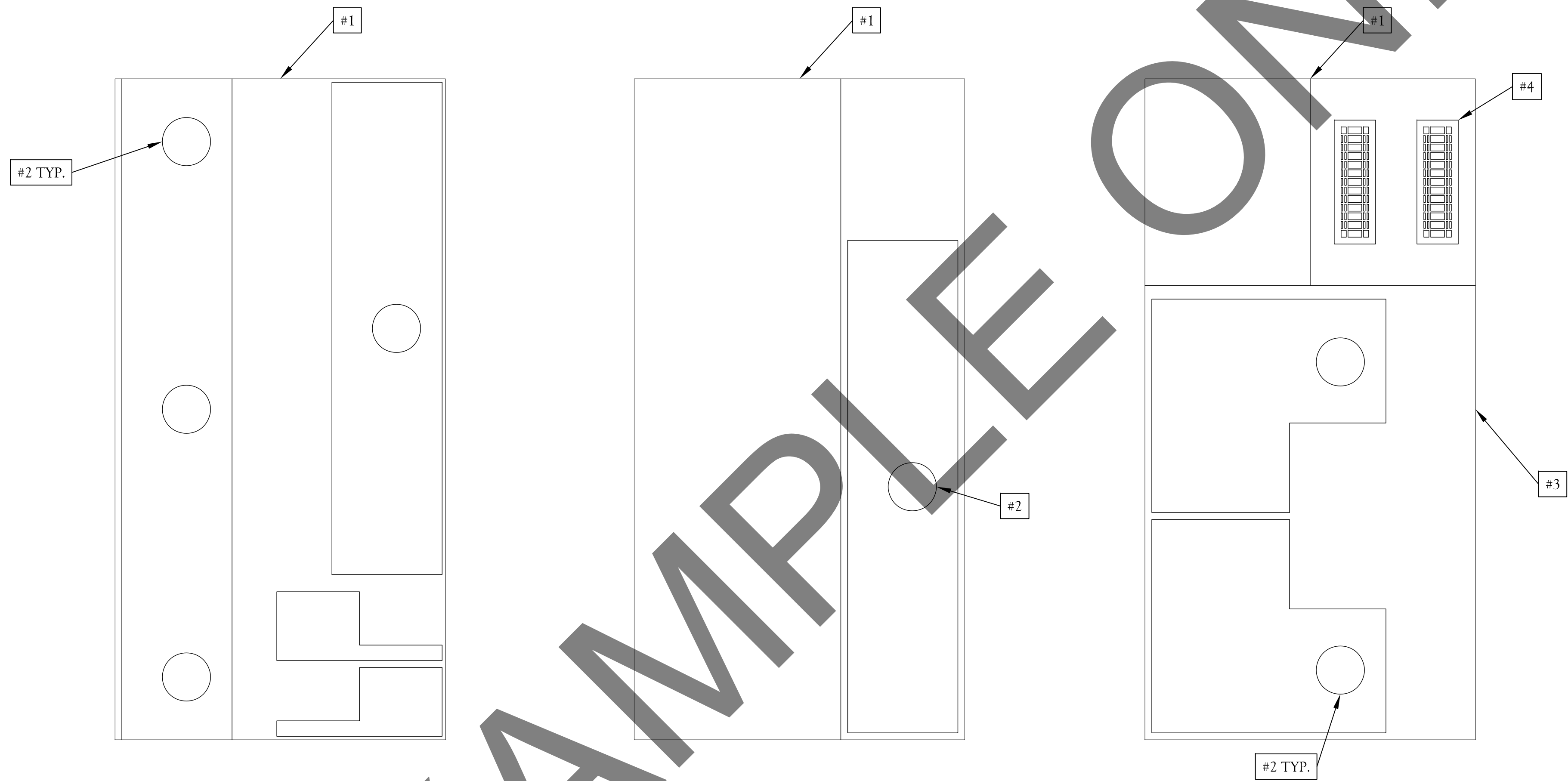

EXAMPLE ONLY