

GOBOS

- G203 Double Hung Window
- R77563M Glass Brick Up
- R78023M Random Lines
- R78643M Sand Trails
- R79664M Reflected Water 3
- R79665M Reflected Water 4

LEGEND

ELLIPSOIDALS

- ETC Source-4 Jr 36° @ 575w 47 / 48
- ETC Source-4 Jr 50deg @ 575w 20 / 20
- ETC Source-4 Jr 25-50 deg Zoom @ 575w 8 / 12
- ETC Source-4 36° @ 575w 1 / 1
- ETC Source-4 50° @ 575w 1 / 1

PARS

- ETC Source 4 PAR MCM (WFL) @ 575w 49 / 50

FRESNELS

- 6" Fres @ 500w 12 / 12

INTELLIGENT

- ColorMix 250 AT @ 390w 1 / 3
- Chauvet Rogue R2 Wash @ 285w 8 / 8

MISC.

- HOUSE LIGHT @ 150w 10 / 12
- Altman Q-Lite-Jr @ 650w 4 / 4
- BIRDIE @ 75w 11 / 13
- Practical @ 100w 1 / 19
- RGB LED Tape 48 / 8
- RGBW LED Tape 24 / 24

ACCESSORIES

- Template Indicator 19 / 19
- APOLLO GOBO ROTATOR 1 / 1
- 7.5" 4 Leaf Barn Door 22 / 12

KEY

- R77491 GOBO
- R60 COLOR
- AWNSAC TEMPLATE INDICATOR
- 12 UNIT #
- 1 CHANNEL #

- NOTES**
- 1) Please have R119 and R132 on hand for focus.
 - 2) Please note gallery positions, and ask if there are questions.
 - 3)
 - 4)
 - 5)
 - 6)

SUBMITTALS

#	DESCRIPTION	DATE
1	INITIAL	08/29/2016
2	PRELIM TO ME	09/02/2016
3	FINAL TO ME	09/09/2016
4		
5		

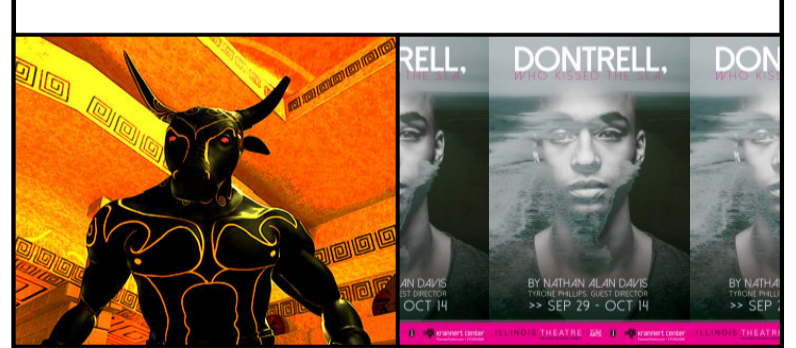

DONTRELL, WHO KISSED THE SEA THE MINOTAUR

ILLINOIS THEATRE

COMBINED LIGHT PLOT

Director
Tyrone Phillips/Tom Mitchell

Lighting Designer - Dontrell
Eric Van Tassell

Lighting Designer - Minotaur
Naomie S. Winch

Stage Manager
Cathy Fazio/Hannah Schumacher

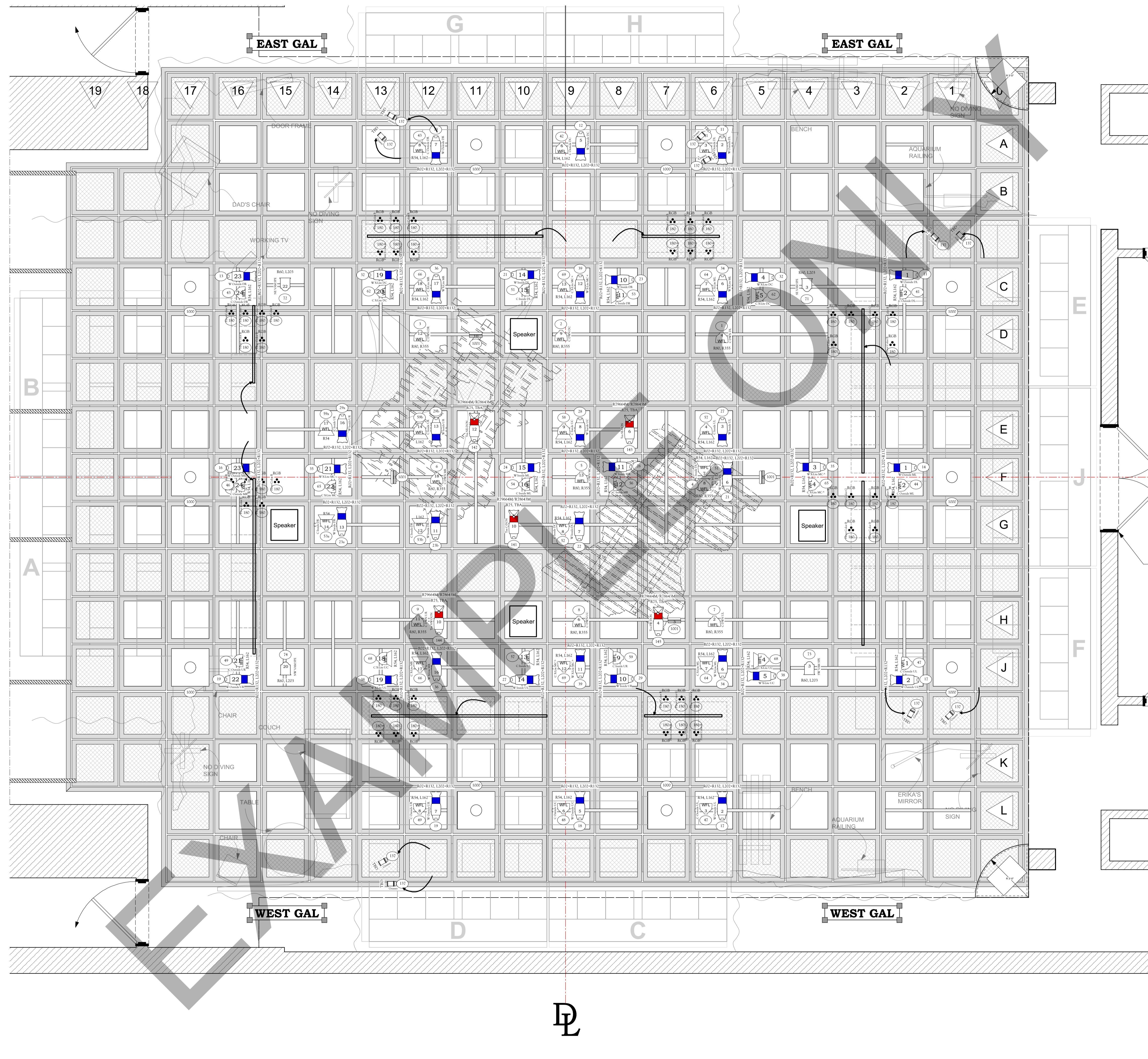

LEGEND

ELLIPSOIDS		
	ETC Source-4 Jr 36° @ 575w	47 / 48
	ETC Source-4 Jr 50deg @ 575w	20 / 20
	ETC Source-4 Jr 25-50 deg Zoom @ 575w	8 / 12
	ETC Source-4 36° @ 575w	1 / 1
	ETC Source-4 50° @ 575w	1 / 1
PARS		
	ETC Source 4 PAR MCM (WFL) @ 575w	49 / 50
FRESNELS		
	6" Fres @ 500w	12 / 12
INTELLIGENT		
	ColorMix 250 AT @ 390w	1 / 3
	Chauvet Rogue R2 Wash @ 285w	8 / 8
MISC.		
	HOUSE LIGHT @ 150w	10 / 12
	Altman Q-Lite-Jr @ 650w	4 / 4
	BIRDIE @ 75w	11 / 13
	Practical @ 100w	1 / 19
	RGB LED Tape	48 / 8
	RGBW LED Tape	24 / 24
ACCESSORIES		
	Template Indicator	19 / 19
	APOLLO GOBO ROTATOR	1 / 1
	7.5" 4 Leaf Barn Door	22 / 12

KEY

	COLOR	R77491	GOBO
	TEMPLATE	R60	
	INDICATOR	12	UNIT #
	PURPOSE	1	CHANNEL #

- NOTES**
- 1) Please have R119 and R132 on hand for focus.
 - 2) Please note gallery positions, and ask if there are questions.
 - 3)
 - 4)
 - 5)
 - 6)

SUBMITTALS

#	DESCRIPTION	DATE
1	INITIAL	08/29/2016
2	PRELIM TO ME	09/02/2016
3	FINAL TO ME	09/09/2016
4		
5		

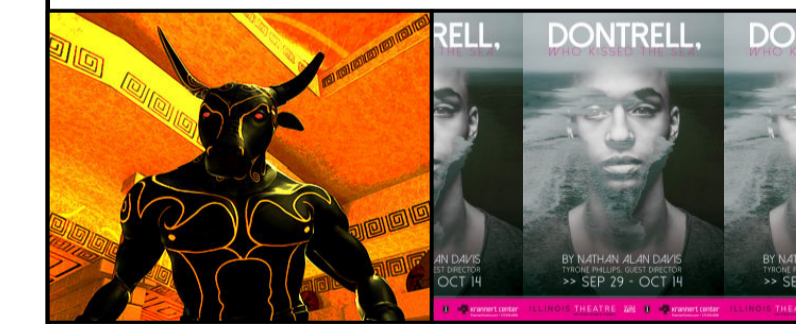

DONTRELL, WHO KISSED THE SEA THE MINOTAUR

ILLINOIS THEATRE

DONTRELL LIGHT PLOT

Director
Tyrone Phillips/Tom Mitchell

Lighting Designer - Dontrell
Eric Van Tassel

Lighting Designer - Minotaur
Naomie S. Winch

Stage Manager
Cathy Fazio/Hannah Schumacher

2 OF 7

SCALE
3/8" = 1'

DRAWN BY
EVT/NSMW

GOBOS

	G203 Double Hung Window
	R77563M Glass Brick Up
	R78023M Random Lines
	R78643M Sand Trails
	R79664M Reflected Water 3
	R79665M Reflected Water 4

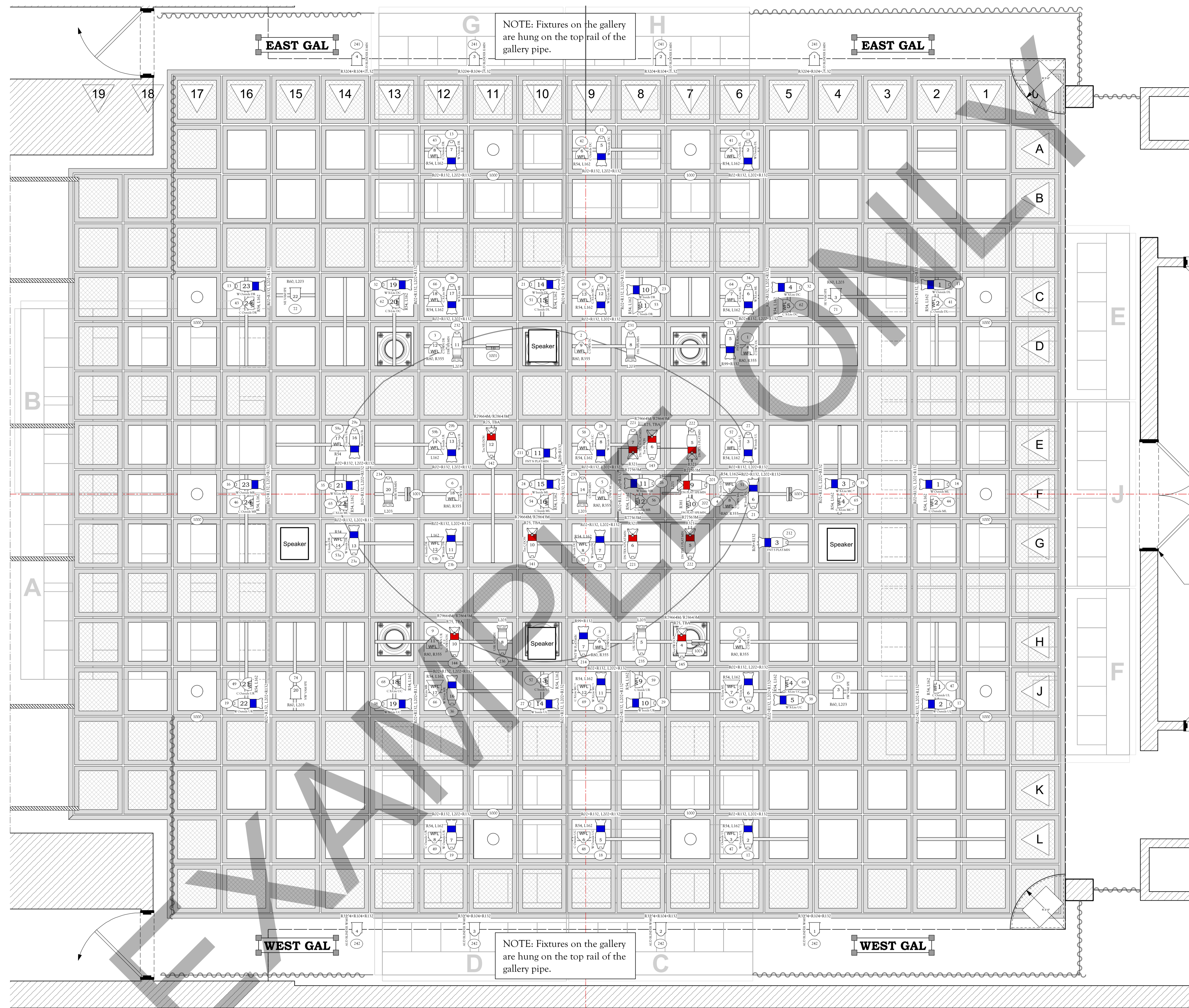

GOBOS

- G203 Double Hung Window
- R77563M Glass Brick Up
- R78023M Random Lines
- R78643M Sand Trails
- R79664M Reflected Water 3
- R79665M Reflected Water 4

LEGEND

ELLIPSOIDS

- ETC Source-4 Jr 36° @ 575w 47 / 48
- ETC Source-4 Jr 50deg @ 575w 20 / 20
- ETC Source-4 Jr 25-50 deg Zoom @ 575w 8 / 12
- ETC Source-4 36° @ 575w 1 / 1
- ETC Source-4 50° @ 575w 1 / 1

PARS

- ETC Source 4 PAR MCM (WFL) @ 575w 49 / 50

FRESNELS

- 6" Fres @ 500w 12 / 12

INTELLIGENT

- ColorMix 250 AT @ 390w 1 / 3
- Chauvet Rogue R2 Wash @ 285w 8 / 8

MISC.

- HOUSE LIGHT @ 150w 10 / 12
- Altman Q-Lite-Jr @ 650w 4 / 4
- BIRDIE @ 75w 11 / 13
- Practical @ 100w 1 / 19
- RGB LED Tape 48 / 8
- RGBW LED Tape 24 / 24

ACCESSORIES

- Template Indicator 19 / 19
- APOLLO GOBO ROTATOR 1 / 1
- 7.5" 4 Leaf Barn Door 22 / 12

KEY

- COLOR R77491 - GOGO
- TEMPLATE R60
- INDICATOR UNIT #
- PURPOSE UNIT #
- CHANNEL #

- NOTES**
- 1) Please have R119 and R132 on hand for focus.
 - 2) Please note gallery positions, and ask if there are questions.
 - 3)
 - 4)
 - 5)
 - 6)

SUBMITTALS

#	DESCRIPTION	DATE
1	INITIAL	08/29/2016
2	PRELIM TO ME	09/02/2016
3	FINAL TO ME	09/09/2016
4		
5		

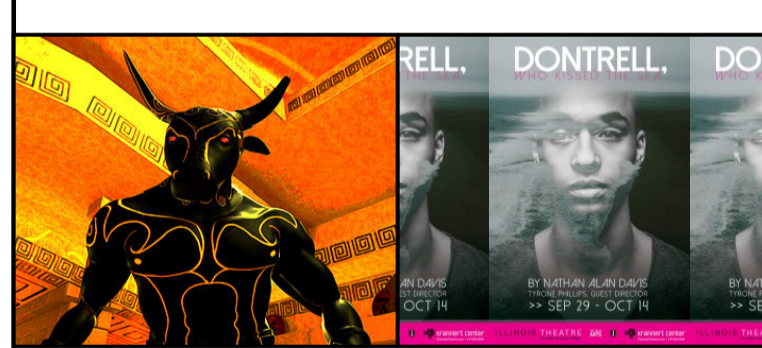

DONTRELL, WHO KISSED THE SEA THE MINOTAUR

ILLINOIS THEATRE

MINOTAUR LIGHT PLOT

Director
Tyrone Phillips/Tom Mitchell

Lighting Designer - Dontrell
Eric Van Tassel

Lighting Designer - Minotaur
Naomie S. Winch

Stage Manager
Cathy Fazio/Hannah Schumacher

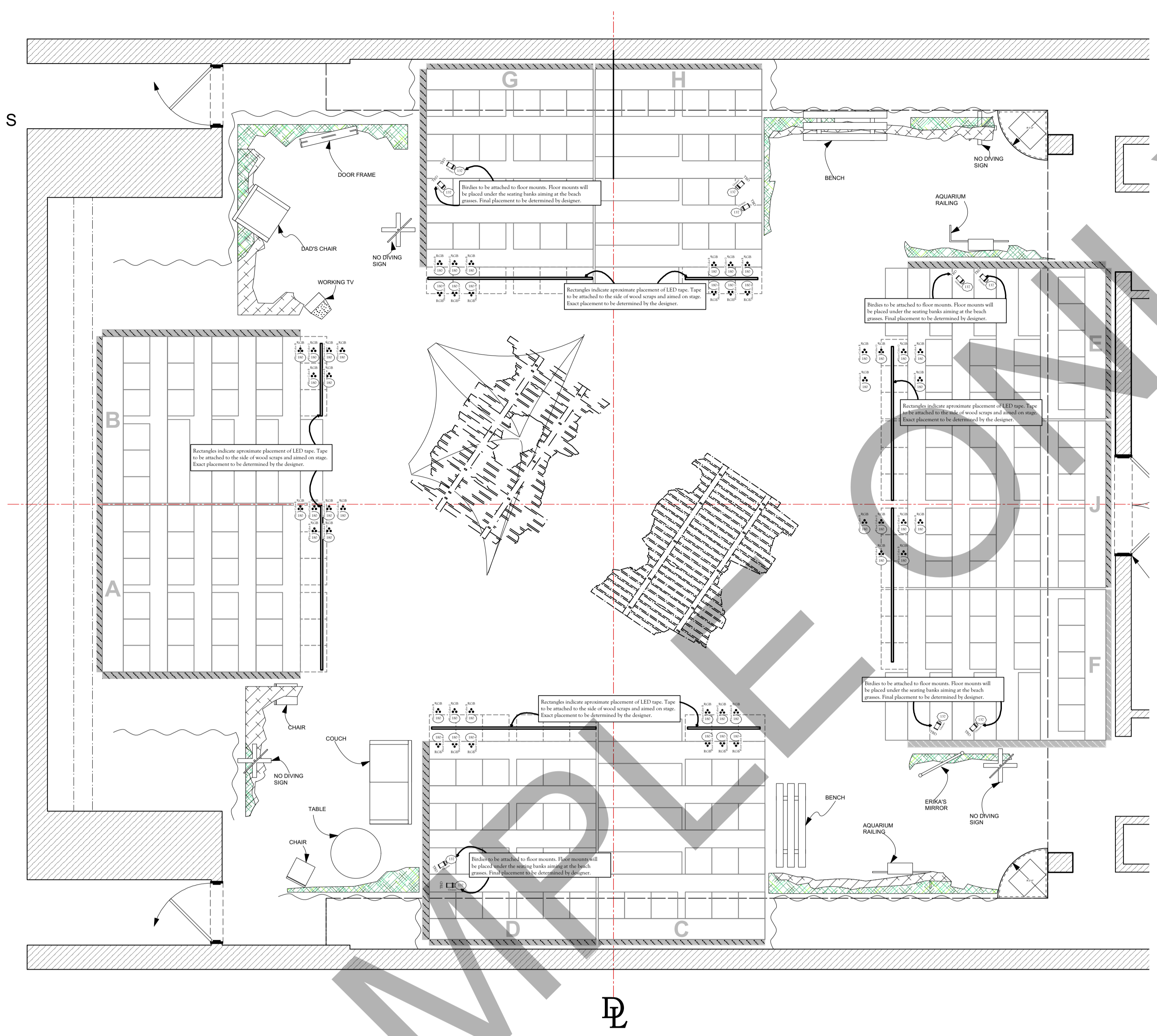
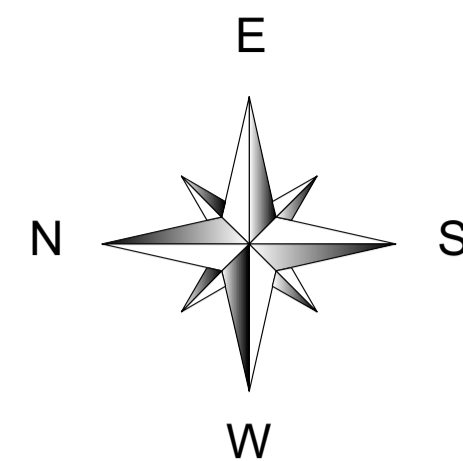

LEGEND

ELLIPSOIDS

- ETC Source-4 Jr 36° @ 575w 47 / 48
- ETC Source-4 Jr 50deg @ 575w 20 / 20
- ETC Source-4 Jr 25-50 deg Zoom @ 575w 8 / 12
- ETC Source-4 36° @ 575w 1 / 1
- ETC Source-4 50° @ 575w 1 / 1

PARS

- ETC Source 4 PAR MCM (WFL) @ 575w 49 / 50

FRESNELS

- 6" Fres @ 500w 12 / 12

INTELLIGENT

- ColorMix 250 AT @ 390w 1 / 3
- Chauvet Rogue R2 Wash @ 285w 8 / 8

MISC.

- HOUSE LIGHT @ 150w 10 / 12
- Altman Q-Lite-Jr @ 650w 4 / 4
- BIRDIE @ 75w 11 / 13
- Practical @ 100w 1 / 19
- RGB LED Tape 48 / 8
- RGBW LED Tape 24 / 24

ACCESSORIES

- Template Indicator 19 / 19
- APOLLO GOBO ROTATOR 1 / 1
- 7.5" 4 Leaf Barn Door 22 / 12

KEY

COLOR ----- R77491 ----- GOBO
 TEMPLATE ----- R60 -----
 INDICATOR ----- AW/NS/C -----
 PURPOSE ----- 12 ----- UNIT #
 ----- 1 ----- CHANNEL #

- NOTES**
- 1) Please have R132 on hand for focus.
 - 2) Please note gallery positions, and ask if there are questions.
 - 3)
 - 4)
 - 5)
 - 6)

SUBMITTALS

#	DESCRIPTION	DATE
1	INITIAL	08/29/2016
2	PRELIM TO ME	09/02/2016
3	FINAL TO ME	09/09/2016
4		
5		

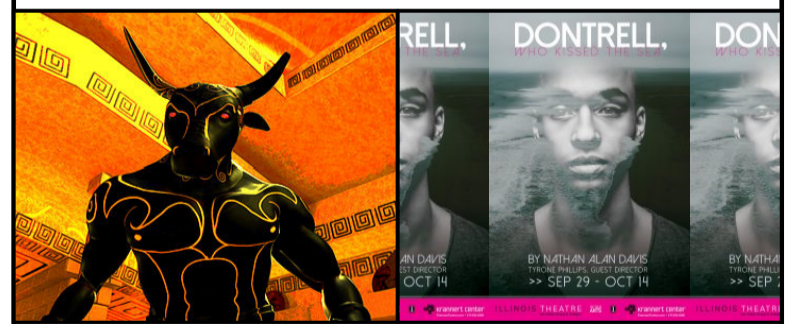

DONTRELL, WHO KISSED THE SEA THE MINOTAUR

ILLINOIS THEATRE

DONTRELL DECK/RIGGING

Director
 Tyrone Phillips/Tom Mitchell

Lighting Designer - Dontrell
 Eric Van Tassell

Lighting Designer - Minotaur
 Naomie S. Winch

Stage Manager
 Cathy Fazio/Hannah Schumacher

T.V. DETAIL

SCALE: 1/2" = 10"

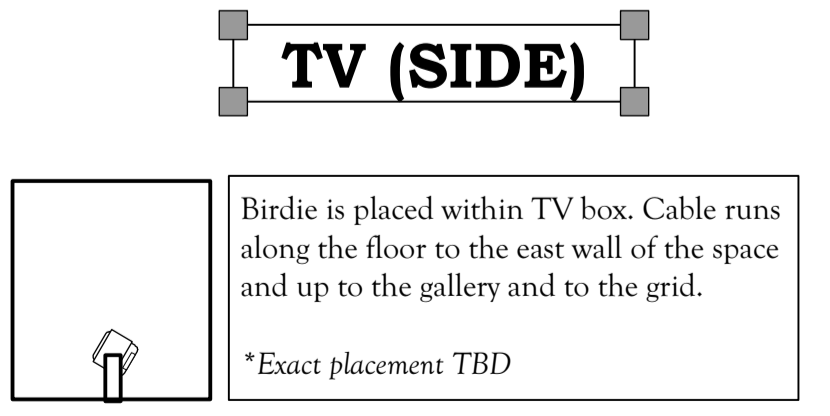
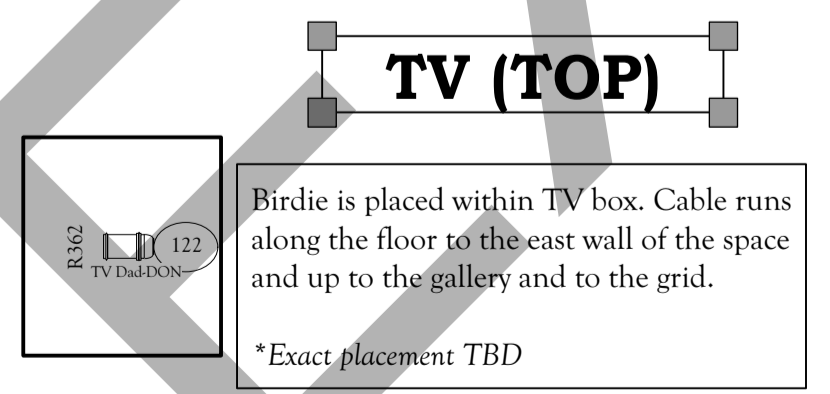

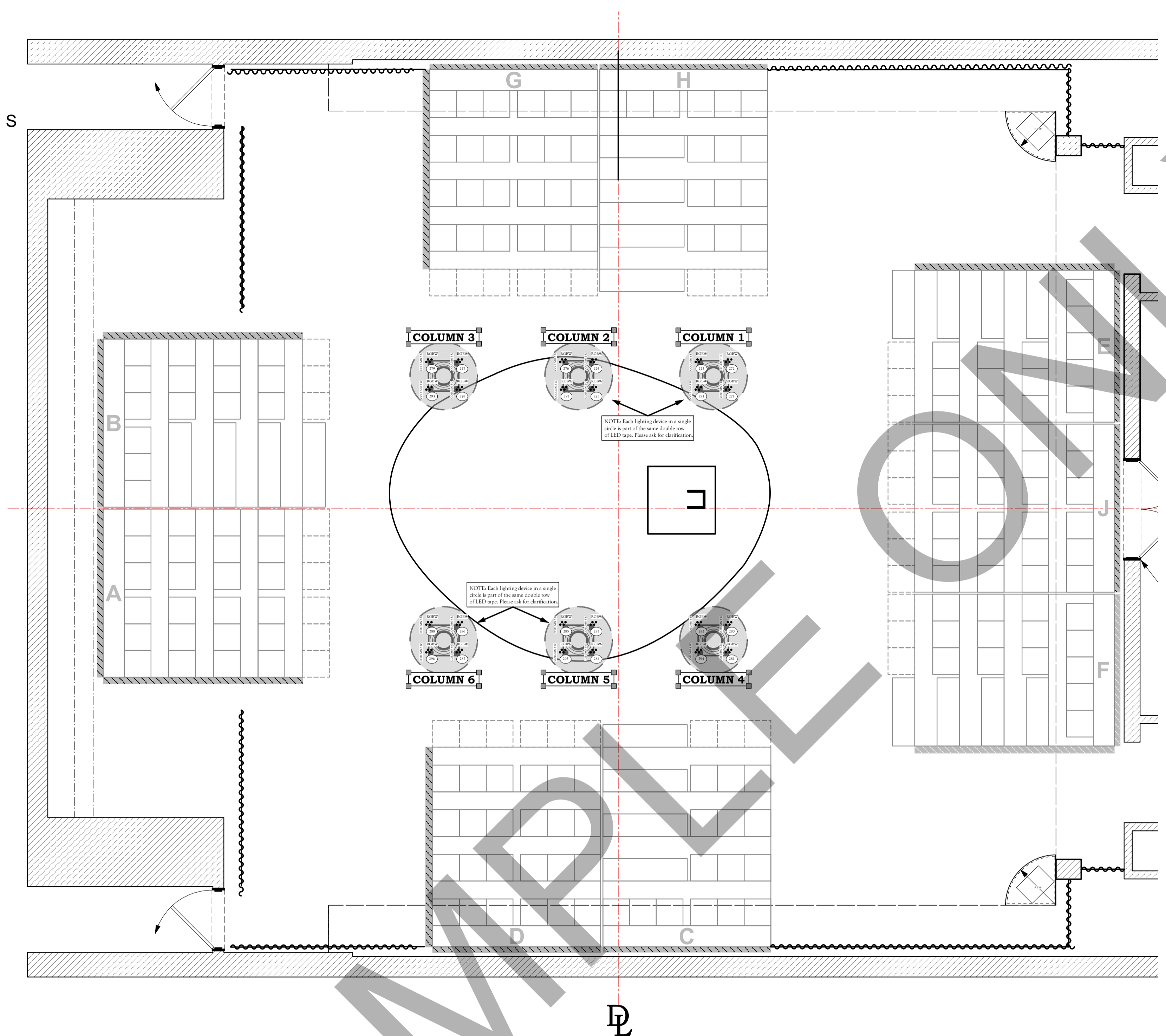
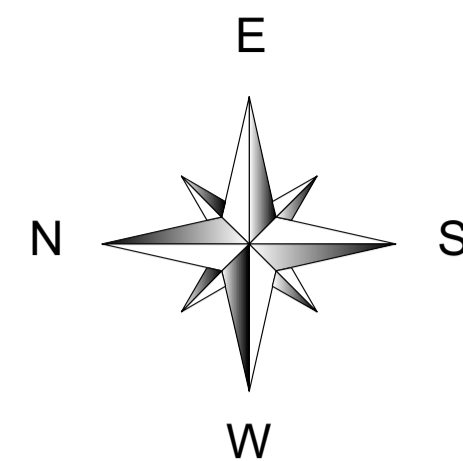

LEGEND

ELLIPSOIDS		
	ETC Source-4 Jr 36° @ 575w	47 / 48
	ETC Source-4 Jr 50deg @ 575w	20 / 20
	ETC Source-4 Jr 25-50 deg Zoom @ 575w	8 / 12
	ETC Source-4 36° @ 575w	1 / 1
	ETC Source-4 50° @ 575w	1 / 1
PARS		
	ETC Source 4 PAR MCM (WFL) @ 575w	49 / 50
FRESNELS		
	6" Fres @ 500w	12 / 12
INTELLIGENT		
	ColorMix 250 AT @ 390w	1 / 3
	Chauvet Rogue R2 Wash @ 285w	8 / 8
MISC.		
	HOUSE LIGHT @ 150w	10 / 12
	Altman Q-Lite-Jr @ 650w	4 / 4
	BIRDIE @ 75w	11 / 13
	Practical @ 100w	1 / 19
	RGB LED Tape	48 / 8
	RGBW LED Tape	24 / 24
ACCESSORIES		
	Template Indicator	19 / 19
	APOLLO GOBO ROTATOR	1 / 1
	7.5" 4 Leaf Barn Door	22 / 12

KEY

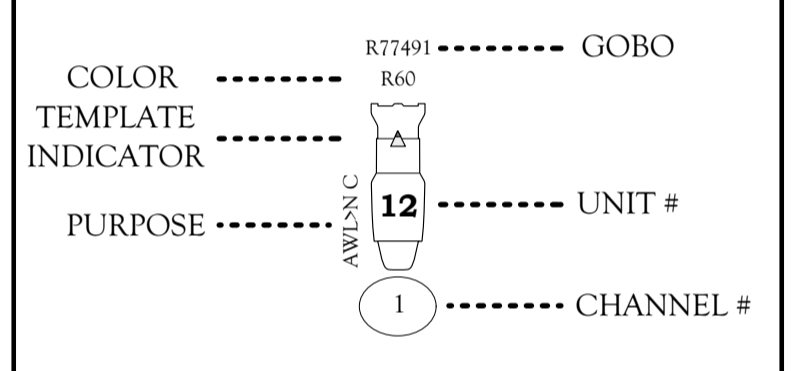

NOTES

- 1) Please have R132 on hand for focus.
- 2) Please note gallery positions, and ask if there are questions.
- 3)
- 4)
- 5)
- 6)

SUBMITTALS

#	DESCRIPTION	DATE
1	INITIAL	08/29/2016
2	PRELIM TO ME	09/02/2016
3	FINAL TO ME	09/09/2016
4		
5		

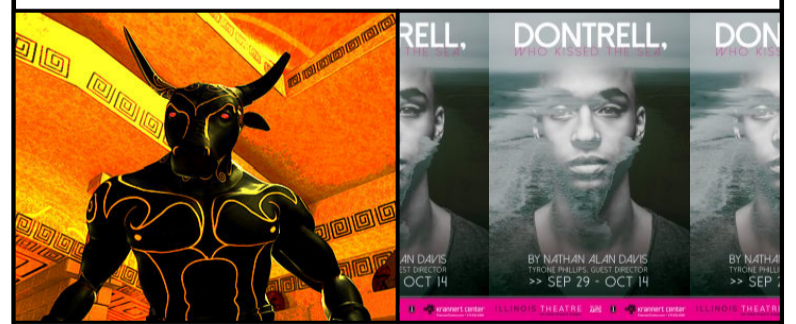

DONTRELL, WHO KISSED THE SEA THE MINOTAUR

ILLINOIS THEATRE

MINOTAUR DECK/RIGGING

Director
Tyrone Phillips/Tom Mitchell

Lighting Designer - Dontrell
Eric Van Tassell

Lighting Designer - Minotaur
Naomie S. Winch

Stage Manager
Cathy Fazio/Hannah Schumacher

COLUMN DETAIL

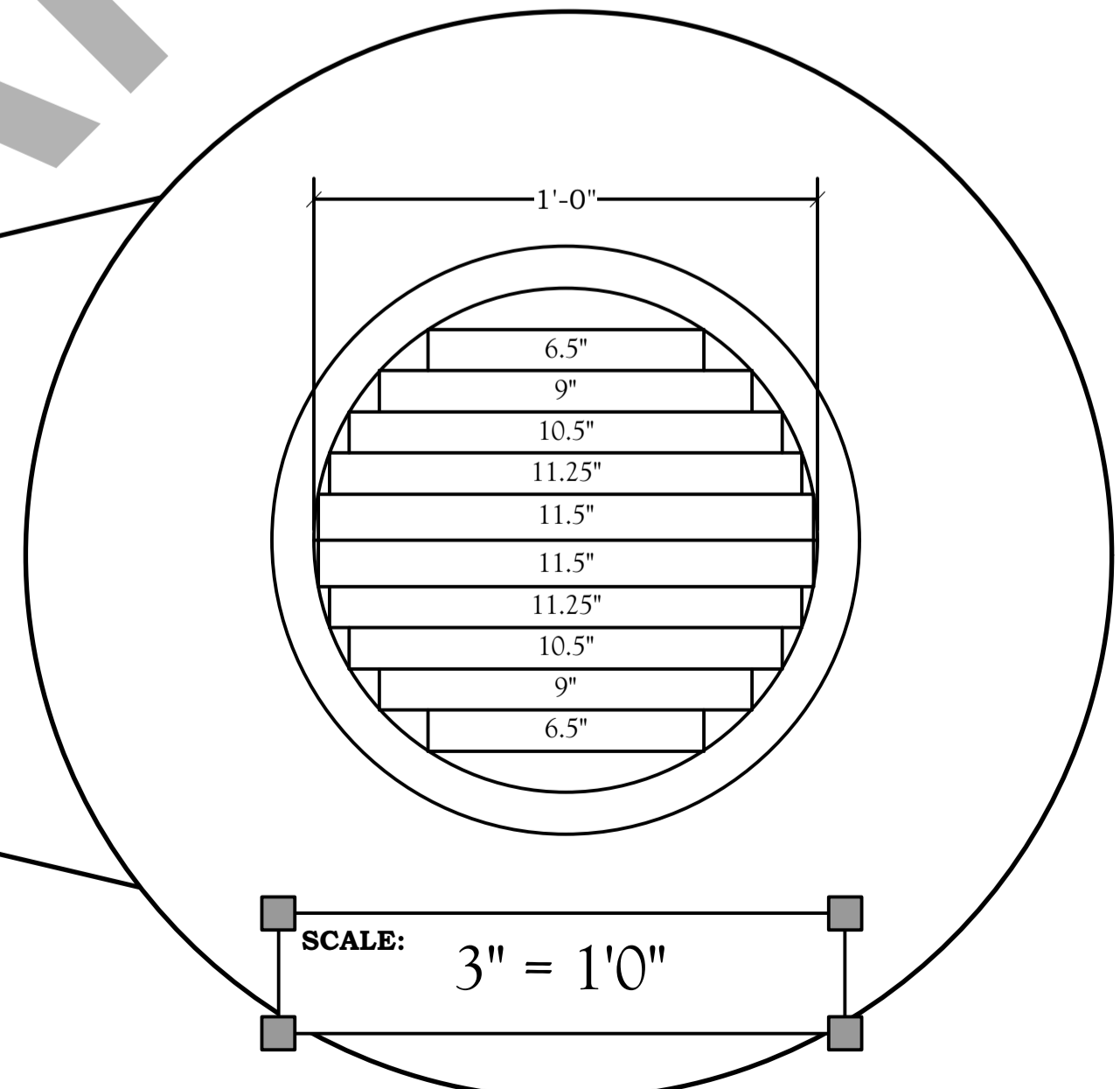
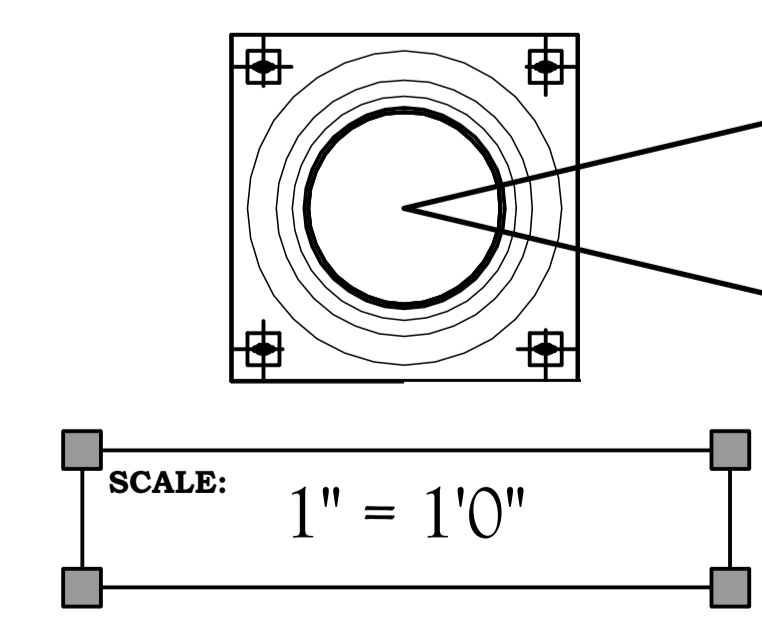

Column plug will be provided by scenic. Please get in contact with the TD to begin building this. Also, please have R132 in 12" diameter, for the possible add of frost.

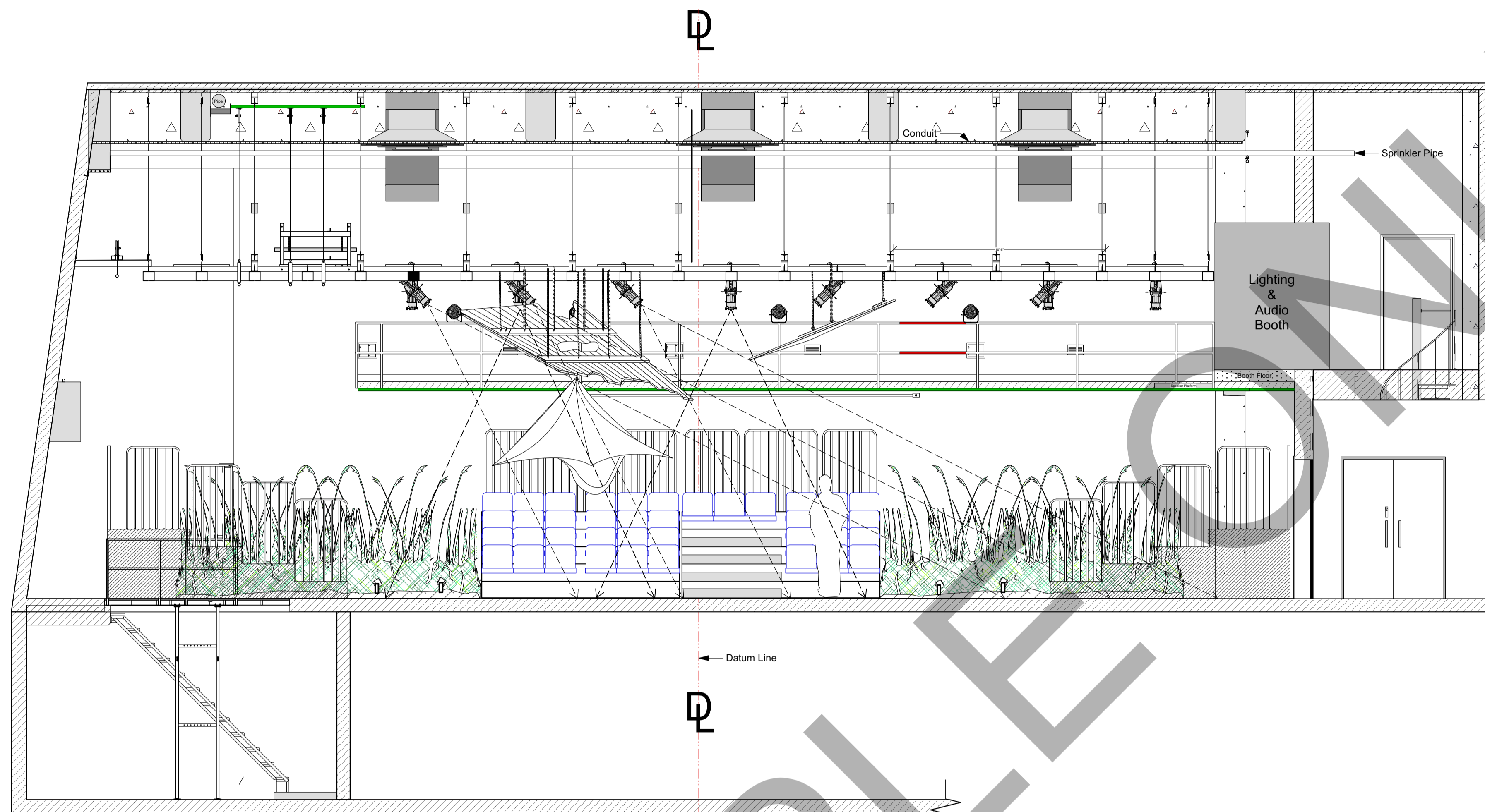

LEGEND

ELLIPSOIDS

	ETC Source-4 Jr 36° @ 575w	47 / 48
	ETC Source-4 Jr 50deg @ 575w	20 / 20
	ETC Source-4 Jr 25-50 deg Zoom @ 575w	8 / 12
	ETC Source-4 36° @ 575w	1 / 1
	ETC Source-4 50° @ 575w	1 / 1

PARS

	ETC Source 4 PAR MCM (WFL) @ 575w	49 / 50
--	-----------------------------------	---------

FRESNELS

	6" Fres @ 500w	12 / 12
--	----------------	---------

INTELLIGENT

	ColorMix 250 AT @ 390w	1 / 3
	Chauvet Rogue R2 Wash @ 285w	8 / 8

MISC.

	HOUSE LIGHT @ 150w	10 / 12
	Altman Q-Lite-Jr @ 650w	4 / 4
	BIRDIE @ 75w	11 / 13
	Practical @ 100w	1 / 19
	RGB LED Tape	48 / 8
	RGBW LED Tape	24 / 24

ACCESSORIES

	Template Indicator	19 / 19
	APOLLO GOBO ROTATOR	1 / 1
	7.5" 4 Leaf Barn Door	22 / 12

KEY

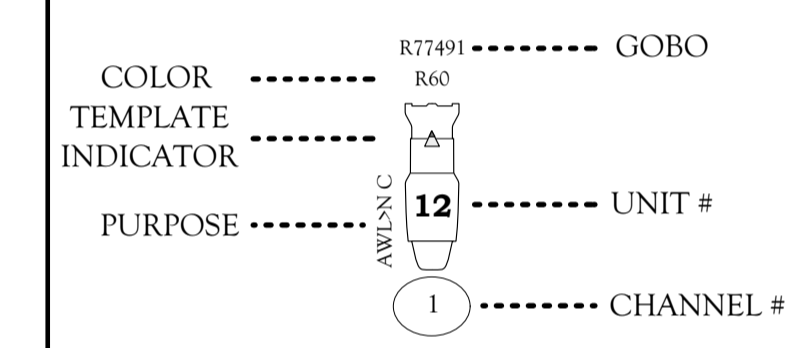

NOTES

- 1) Please have R132 on hand for focus.
- 2) Please note gallery positions, and ask if their are questions.
- 3)
- 4)
- 5)
- 6)

SUBMITTALS

#	DESCRIPTION	DATE
1	INITIAL	08/29/2016
2	PRELIM TO ME	09/02/2016
3	FINAL TO ME	09/09/2016
4		
5		

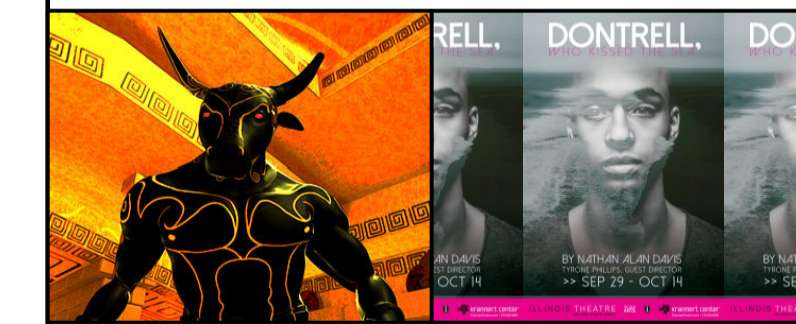

DONTRELL, WHO KISSED THE SEA THE MINOTAUR

ILLINOIS THEATRE

DONTRELL SECT

Director
Tyrone Phillips/Tom Mitchell

Lighting Designer - Dontrell
Eric Van Tassell

Lighting Designer - Minotaur
Naomie S. Winch

Stage Manager
Cathy Fazio/Hannah Schumacher

FORT DETAIL

FORT (TOP)

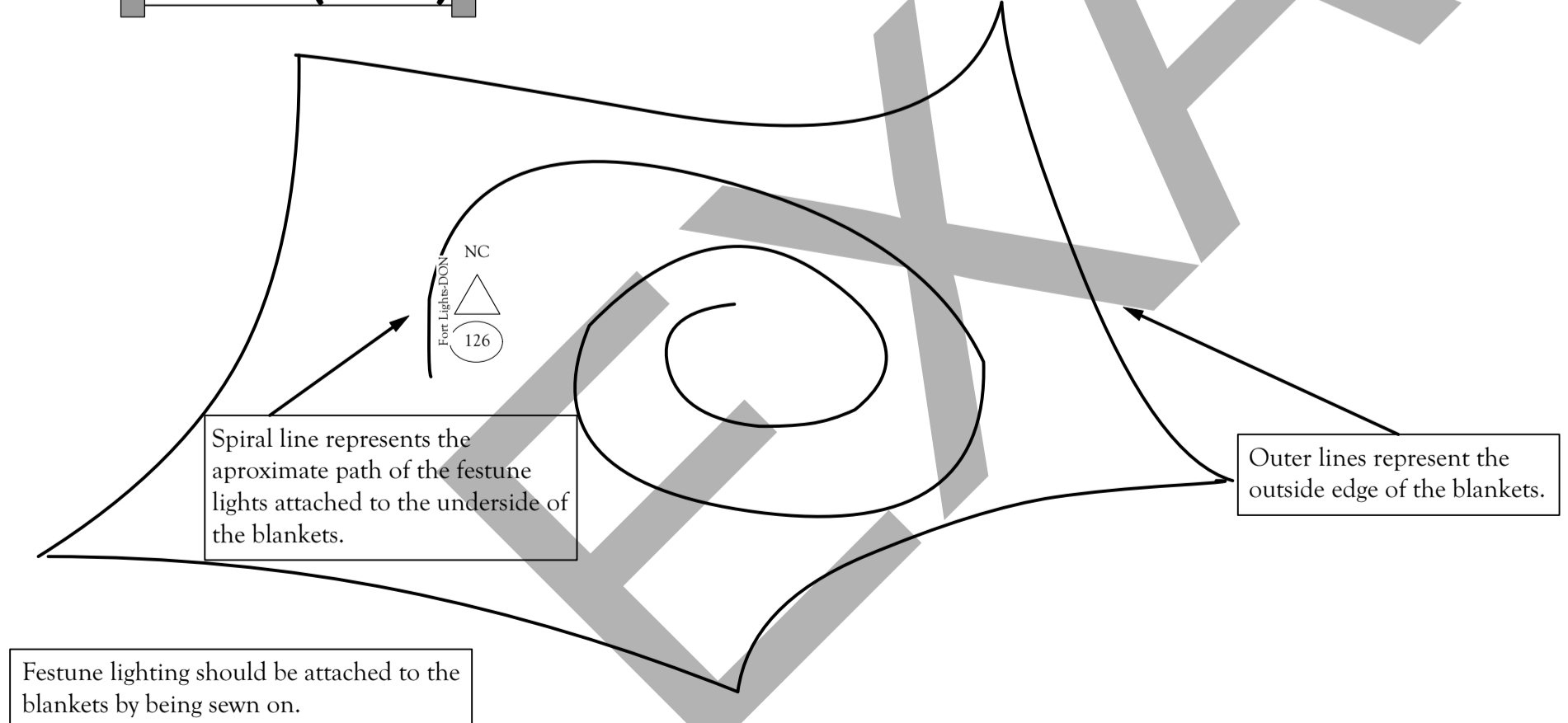

SCALE: NTS

FORT (ISO)

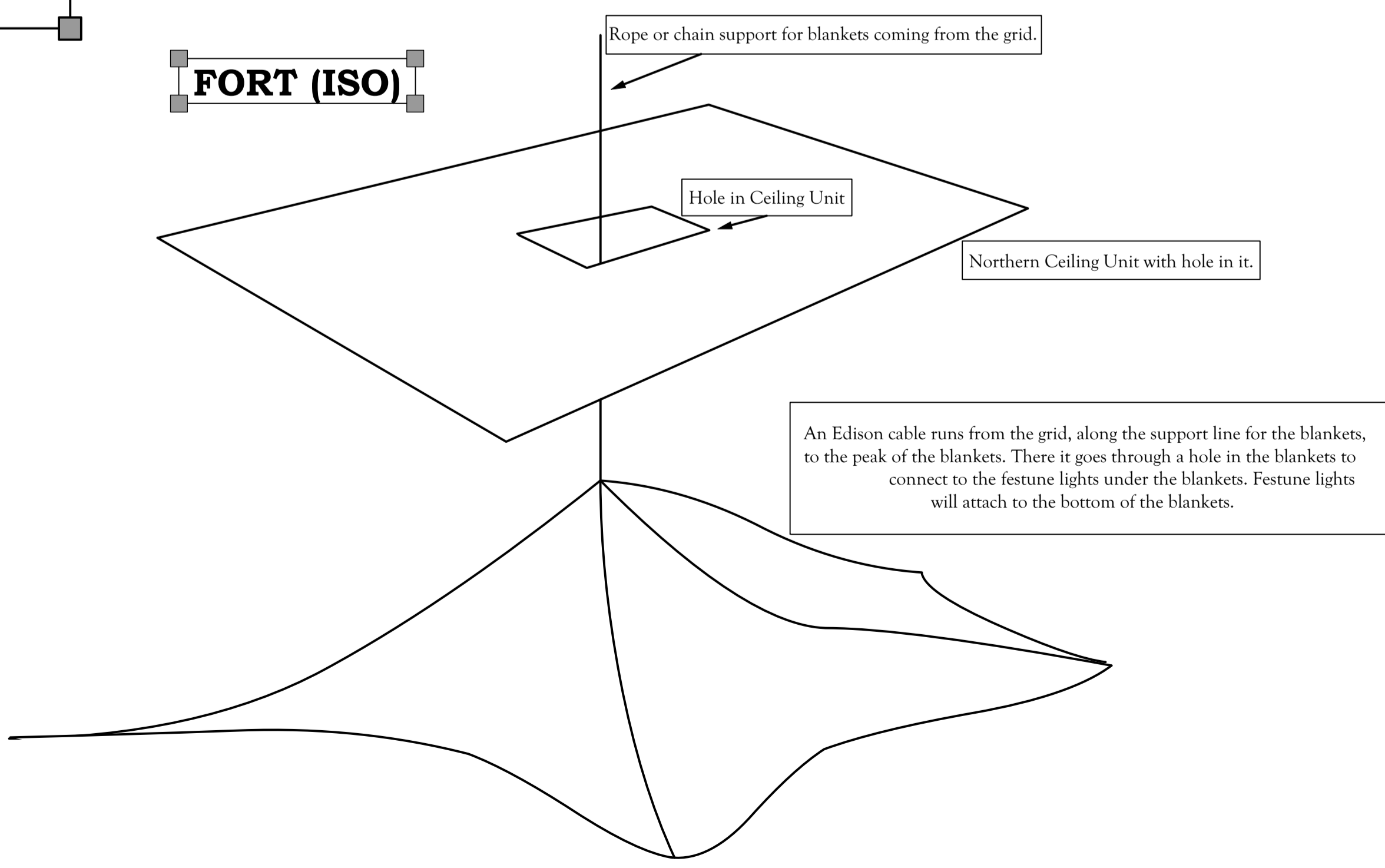

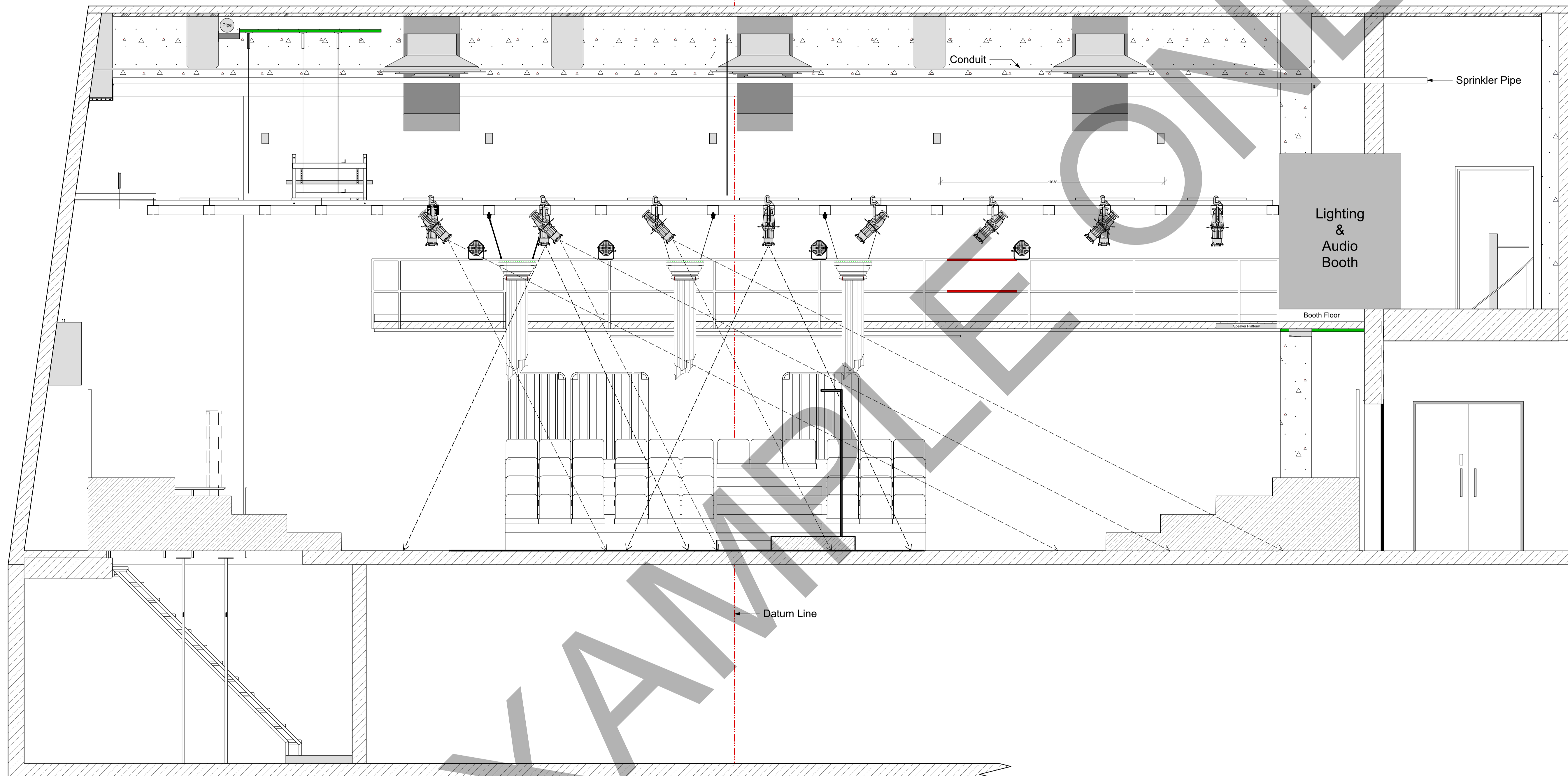

LEGEND

- ELLIPSOIDALS**
- ETC Source-4 Jr 36° @ 575w 47 / 48
 - ETC Source-4 Jr 50deg @ 575w 20 / 20
 - ETC Source-4 Jr 25-50 deg Zoom @ 575w 8 / 12
 - ETC Source-4 36° @ 575w 1 / 1
 - ETC Source-4 50° @ 575w 1 / 1

- PARS**
- ETC Source 4 PAR MCM (WFL) @ 575w 49 / 50

- FRESNELS**
- 6° Fres @ 500w 12 / 12

- INTELLIGENT**
- ColorMix 250 AT @ 390w 1 / 3
 - Chauvet Rogue R2 Wash @ 285w 8 / 8

- MISC.**
- HOUSE LIGHT @ 150w 10 / 12
 - Altman Q-Lite-Jr @ 650w 4 / 4
 - BIRDIE @ 75w 11 / 13
 - Practical @ 100w 1 / 19
 - RGB LED Tape 48 / 8
 - RGBW LED Tape 24 / 24

- ACCESSORIES**
- Template Indicator 19 / 19
 - APOLLO GOBO ROTATOR 1 / 1
 - 7.5' 4 Leaf Barn Door 22 / 12

KEY

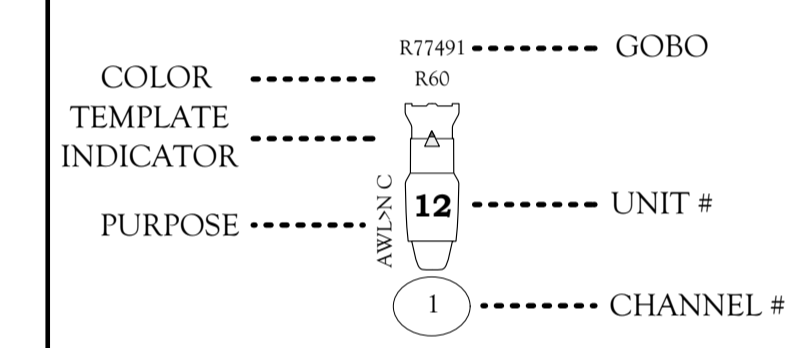

NOTES

- 1) Please have R132 on hand for focus.
- 2) Please note gallery positions, and ask if there are questions.
- 3)
- 4)
- 5)
- 6)

SUBMITTALS

#	DESCRIPTION	DATE
1	INITIAL	08/29/2016
2	PRELIM TO ME	09/02/2016
3	FINAL TO ME	09/09/2016
4		
5		

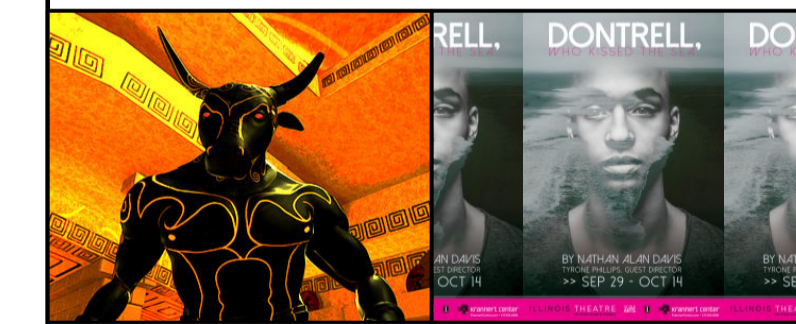

DONTRELL, WHO KISSED THE SEA THE MINOTAUR

ILLINOIS THEATRE

MINOTAUR SECT

Director
Tyrone Phillips/Tom Mitchell

Lighting Designer - Dontrell
Eric Van Tassell

Lighting Designer - Minotaur
Naomie S. Winch

Stage Manager
Cathy Fazio/Hannah Schumacher

7 OF 7

SCALE
3/8" = 1'

DRAWN BY
EVT/NSMW

