

208v/120v Distribution – She Loves Me

208v Distro

SOCA A1 – SR Torm

SOCA A2 – SL Torm

SOCA A3 – LX 1

SOCA A4 – LX 2B

SOCA A5 – LX 3B AURAS

SOCA A6 – LX 3B ROBINS

SOCA B1 – LX 4B

120v Distro

EDISON 1 – USL Opto Splitter
(on top of 24 rack)

EDISON 2 – SL Gallery (Opto
& Scroller PSU)

EDISON 3 – SL Boom 3 (RC4
Transceiver)

EDISON 4 – SR Gallery (Opto
& Scroller PSU)

EDISON 5 – US Rope light

EDISON 6 – LED Driver PSU

EDISON 7 – Deck LEP Pack

EDISON 8 – Deck LEP Pack

SHE LOVES ME 208v Power Distribution

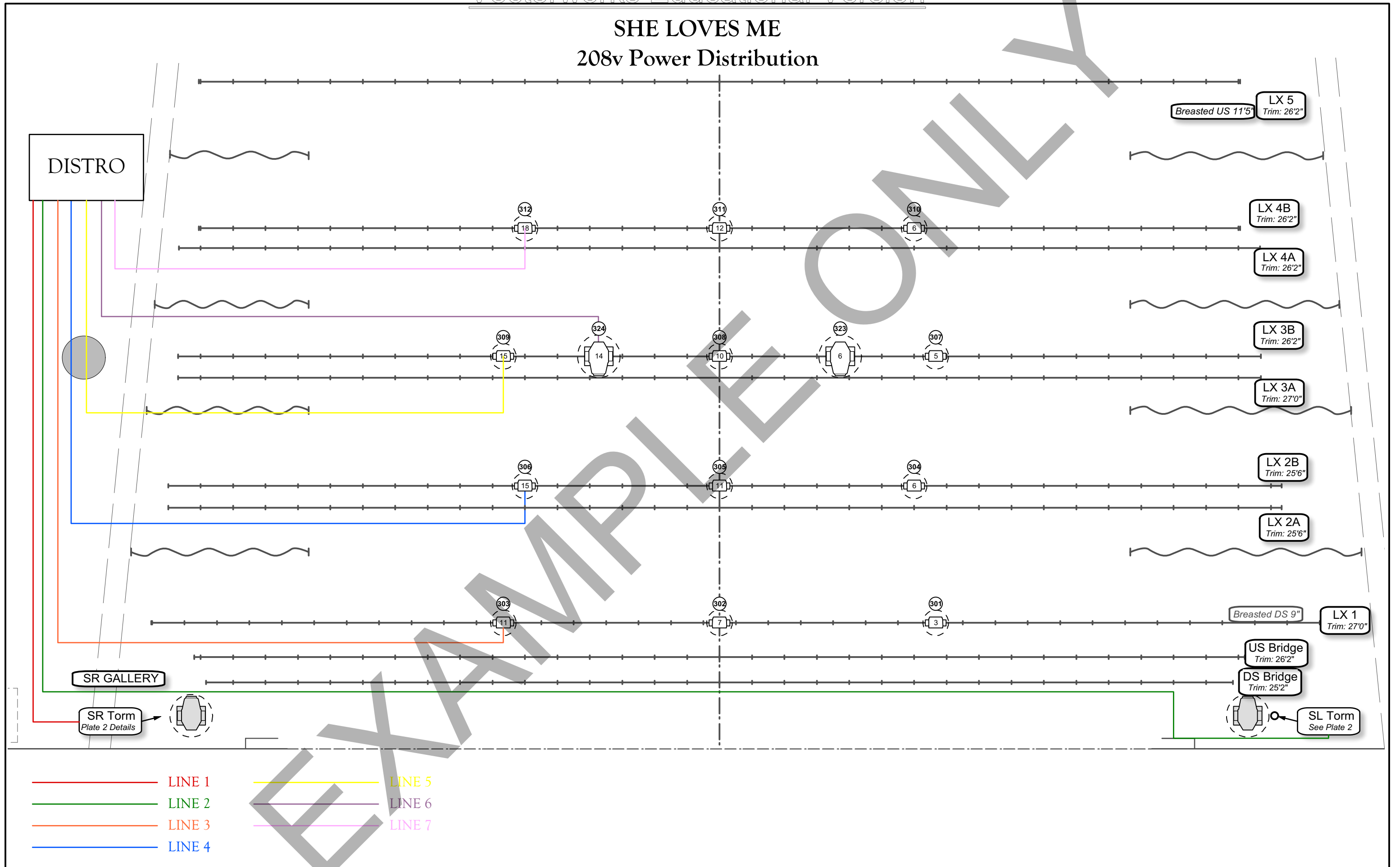

Dimmer Rack Soca Distro – She Loves Me

SOCA A (401-406)

- SR Torm

SOCA B (407-412) – *Split at Gallery*

- 407-409: SR Torm
- 410: Lineset #9 (Main Chandelier)
- 411-412: Lineset #14 (Secondary Chandeliers)

SOCA C (413-418)

- LX 3A

SOCA D (419-424) – *Split at Gallery*

- 419-420: LX 3A
- 421-424: LX 3B

SOCA E (425-430)

- LX 3B

SOCA F (431-436) – *Split at Gallery*

- 431-432: LX 4A
- 433-436: LX 4B

SOCA G (437-442)

- LX 4B

SOCA H (443-448)

- LX 5

NOTE: All circuits run up to the SR gallery before being dropped in to respective locations.

DMX Distribution – She Loves Me

SL Gallery Opto

Line 1 – SL Scroller PSU

Line 2 – SL Torm

Line 3 – LX 1

Line 4 – LX 2B

SR Gallery Opto

Line 1 – SR Scroller PSU

Line 2 – SR Torm

Line 3 – LX 3B

Line 4 – N/A

USL “24 Rack” Opto

Line 1 – LX 4B

Line 2 – Shelves LED Drivers

Line 3 – SR Boom 3 (RC4
Transceiver)

Line 4 – Possible LEP Pack

SHE LOVES ME 120v Power Distribution

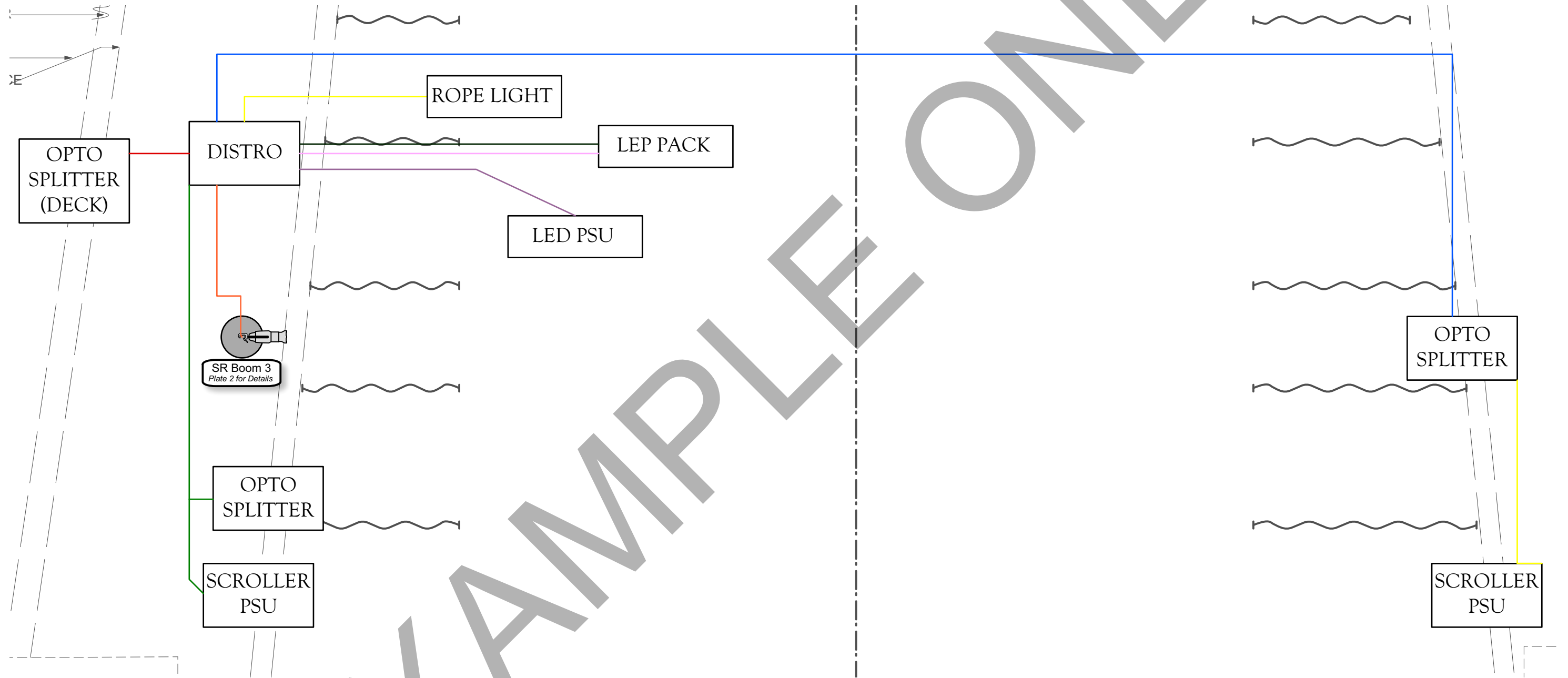

- LINE 1
- LINE 2
- LINE 3
- LINE 4
- LINE 5
- LINE 6
- LINE 7
- LINE 8

SHE LOVES ME DMX Distribution

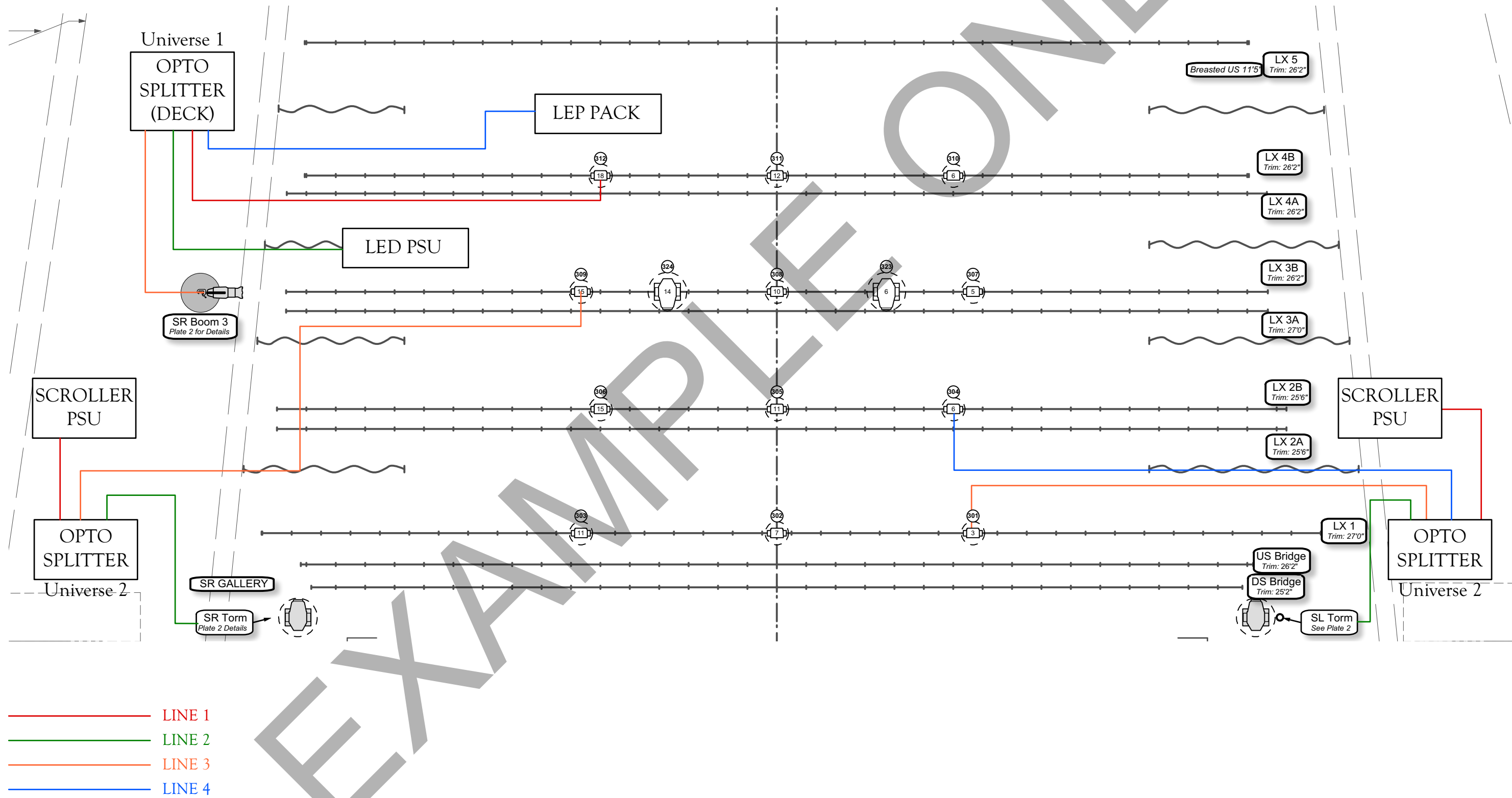

Address & Location List – She Loves Me

SL SIDE SLOT

- U#9 (Scroller) – 2/451
- U#10 (Scroller) – 2/452
- U#11 (Scroller) – 2/453
- U#12 (Scroller) – 2/454

SL TORM

- Robe Robin – 2/395
- Mac 301 – 2/226
- U#2 (Scroller) – 2/455
- U#3 (Scroller) – 2/456
- U#4 (Scroller) – 2/457

SR SIDE SLOT

- U#9 (Scroller) – 2/461
- U#10 (Scroller) – 2/462
- U#11 (Scroller) – 2/463
- U#12 (Scroller) – 2/464

SR TORM

- Robe Robin – 2/465
- Mac 301 – 2/251
- U#2 (Scroller) – 2/276
- U#3 (Scroller) – 2/277
- U#4 (Scroller) – 2/278

LX 1

- SL Aura – 2/1
- CS Aura – 2/26
- SR Aura – 2/51

LX 2B

- SL Aura – 2/76
- CS Aura – 2/101
- SR Aura – 2/126

LX 3B

- SL Aura – 2/151
- SL Robe Robin – 2/301
- CS Aura – 2/176
- SR Robe Robin – 2/348
- SR Aura – 2/201

LX 4B

- SL Aura – 1/301
- CS Aura – 1/326
- SR Aura – 1/351

SL SHELVES

- Driver – 1/381

SR SHELVES

- Driver – 1/382

BEDROOM

- RC4 – 1/391

COUNTERS

- SL RC4 – 1/391
- CS RC4 – 1/397
- SR RC4 – 1/393

24 Rack A – 1/401

24 Rack B – 1/425

DECK LEP PACK (if needed)

- LEP Pack – 1/451

Trim Heights/Dropbox Placement – SLM

TRIM HEIGHTS

DS LIGHT BRIDGE

25'2"

US LIGHT BRIDGE

26'2"

LX 1 – L.S. 1 (Breasted 9" DS)

27'0"

LX 2A – L.S. 6

25'6"

LX 2B – L.S. 7

25'6"

LX 3A – L.S. 12

27'0"

LX 3B – L.S. 13

26'2"

LX 4A – L.S. 18

26'2"

LX 4B – L.S. 19

26'2"

LX 5 – L.S. 22 (Breasted 11.5" US)

26'2"

DROPBOX PLACEMENT

L 1/8 – LX 1

L 2/8 – LX 2B

L 3/6 – SL Gallery MS

L 4/4 – SL Gallery MS

L CYC/6 – SL Gallery US

R 1/8 – SR Gallery DS

R 2/8 – LX 2A

R 3/4 – LX 2B

R 4/8 – LX 4A

R CYC/6 – LX 4B

Load-in Checklist – She Loves Me

- Hang Over Stage
 - Hang, Circuit, Color & Gobo
 - Ring out & Tie Up
 - Weight the Electrics
- Run 208v/120v Power
- Run DMX
- Run Dimmer Rack Soca
- Hang FoH
 - Added fixtures in Side Slots & Ceiling Slot #2
 - Hang, Circuit, Color & Gobo
 - Ring out
- Hang Galleries
 - Hang, Circuit, Color & Gobo
 - Ring out & Tie Up
- Construct Rovers
- Hang SL Booms
 - Boom 1 is a Rover!
 - Hang, Circuit, Color & Gobo
 - Ring out & Tie Up
- Hang SR Booms (wait until scenery loadin is done – if need be for things to do, build booms to the side)
 - Boom 1 is a Rover!
 - Hang, Circuit, Color & Gobo
 - Ring out & Tie Up
- Work on Practicals
 - Chandeliers (complete wiring job)
 - All 4 arms of the chandelier are wired in parallel (end up with 5 hot wires in 1 wire nut & 5 neutral wires in 1 wire nut – add a metal strain relief at the top)
 - Counters (LED tape install, battery & RC4 unit test)
 - Shelves (LED tape install, battery & RC4 unit test)
 - Hospital Room (Battery & RC4 unit test)
 - Wall sconce (Run cable & make pretty)
- ME stuff
 - Load Show File
 - RC4 Setup
 - SL Counter/Bedroom (2CH A)– 1/391

- CS Counter (2CH B) – 1/393
- SR Counter (4CH) – 1/397
- Wireless Battery/DMX Setup
 - Transfer battery (SL counter & bedroom): Battery terminal → ring terminal → 18GA wire → F QC → M QC → 18GA wire → RC4
 - Transfer DMX (SL counter & bedroom): LED tape → 18GA/Ethernet → M QC → F QC → 18GA wire → RC4
 - Regular battery: Battery terminal → ring terminal → 18GA wire → RC4
 - Regular DMX: LED Tape → 18GA/Ethernet → RC4

EXAMPLE ONLY

LIGHT BRIDGE

HANG CARD & NOTES

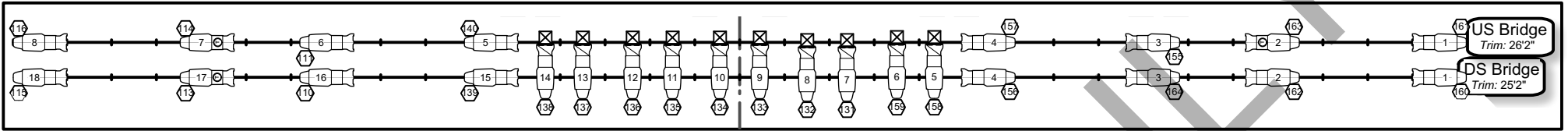

NOTES:

- Frost/Diffusion for color is a separate column in lightwright.
- All circuits directly from the lightbridge.
- Please do not forget to drop top hats in fixtures.
- Please run circuits 107-109 to the SR Gallery.

CONVENTIONALS:	MOVING LIGHTS:
Source 4 19 deg - 575w Source 4 26 deg - 575w Source 4 36 deg - 575w Source 4 50 deg - 575w Source 4 19 deg - 750w Source 4 10 deg - 750w Source 4 5 deg - 750w PAR 64 WFL - 1kw 8" Fresnel - 1kw Source 4 PAR WFL - 575w Source 4 PAR MFL - 575w	Robe Robin DLS Top View Front View Side View Martin MAC Aura Top View Front View Side View Martin MAC 301 Top View Front View Side View ACCESSORIES: 6.25" Top Hat 6.25" Half Hat Wybron Forerunner Color Scroller Template Holder Source 4 Drop In Iris Source 4 Handle 7.5" 4 Panel Barn Door 10" 4 Panel Barn Door

LX 1

HANG CARD & NOTES

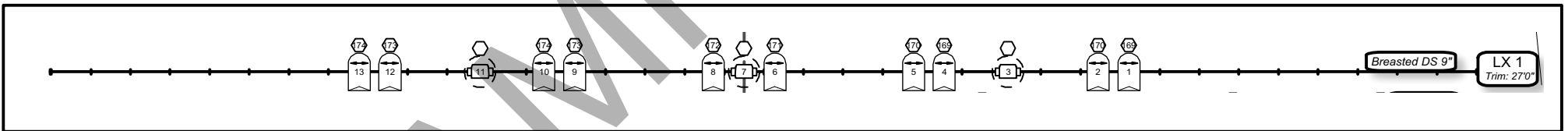

NOTES:

- Frost/Diffusion for color is a separate column in lightwright.
- Note arrow direction of PAR Bottle.
- Gets dropbox L 1/8
- Circuits come from L 1/8
- DMX comes from SL Gallery Opto Splitter Line 3
 - See lightwright for addressing
- Constant power comes from SR Gallery 208v Line A3
- Please run circuits 175-176 to the SL Torm

CONVENTIONALS:	MOVING LIGHTS:
Source 4 19 deg - 575w Source 4 26 deg - 575w Source 4 36 deg - 575w Source 4 50 deg - 575w Source 4 19 deg - 750w Source 4 10 deg - 750w Source 4 5 deg - 750w PAR 64 WFL - 1kw 8" Fresnel - 1kw Source 4 PAR WFL - 575w Source 4 PAR MFL - 575w	Robe Robin DLS Top View Front View Side View Martin MAC Aura Top View Front View Side View Martin MAC 301 Top View Front View Side View ACCESSORIES: 6.25" Top Hat 6.25" Half Hat Wybron Forerunner Color Scroller Template Holder Source 4 Drop In Iris Source 4 Handle 7.5" 4 Panel Barn Door 10" 4 Panel Barn Door

SL GALLERY

HANG CARD & NOTES

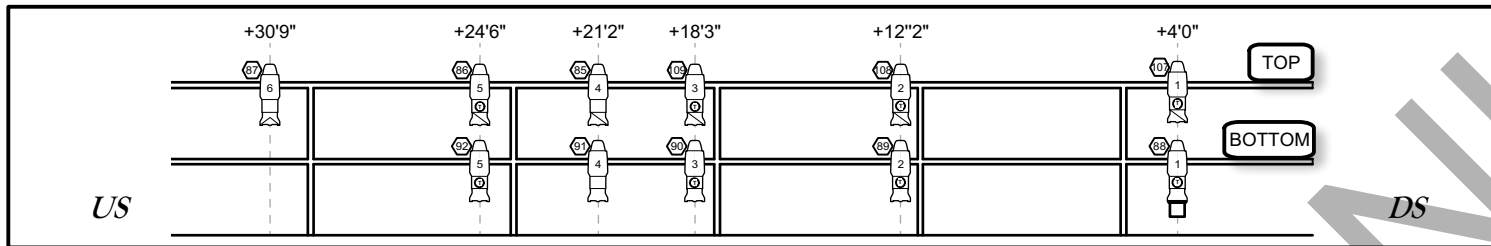

NOTES:

- Frost/Diffusion for color is a separate column in lightwright.
- Gets dropboxes L 3/6, L 4/3, L CYC/6
- All circuits come from the dropboxes on the gallery.
- All measurements seen above are from Plasterline or the Wall on the gallery going US.
- Don't forget the top hat!

CONVENTIONALS:	MOVING LIGHTS:
Source 4 19 deg - 575w	Robe Robin DLS Top View Front View Side View
Source 4 26 deg - 575w	Top View Front View Side View
Source 4 36 deg - 575w	Martin MAC Aura Top View Front View Side View
Source 4 50 deg - 575w	Top View Front View Side View
Source 4 19 deg - 750w	Martin MAC 301 Top View Front View Side View
Source 4 10 deg - 750w	Top View Front View Side View
Source 4 5 deg - 750w	
PAR 64 WFL - 1kw	ACCESSORIES:
8" Fresnel - 1kw	6.25" Top Hat
Source 4 PAR WFL - 575w	6.25" Half Hat
Source 4 PAR MFL - 575w	Wybron Forerunner Color Scroller
	Template Holder
	Source 4 Drop In Iris
	Source 4 Handle
	7.5" 4 Panel Barn Door
	10" 4 Panel Barn Door

SR GALLERY

HANG CARD & NOTES

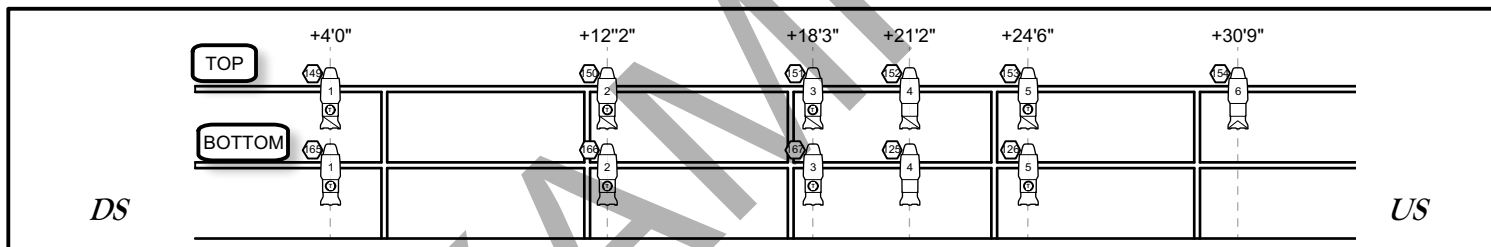

NOTES:

- Frost/Diffusion for color is a separate column in lightwright.
- Gets dropboxes R 1/8
- Circuits come from the dropbox on the gallery and the SR light bridge (107-109).
- All measurements seen above are from Plasterline or the Wall on the gallery going US.

CONVENTIONALS:	MOVING LIGHTS:
Source 4 19 deg - 575w	Robe Robin DLS Top View Front View Side View
Source 4 26 deg - 575w	Top View Front View Side View
Source 4 36 deg - 575w	Martin MAC Aura Top View Front View Side View
Source 4 50 deg - 575w	Top View Front View Side View
Source 4 19 deg - 750w	Martin MAC 301 Top View Front View Side View
Source 4 10 deg - 750w	Top View Front View Side View
Source 4 5 deg - 750w	
PAR 64 WFL - 1kw	ACCESSORIES:
8" Fresnel - 1kw	6.25" Top Hat
Source 4 PAR WFL - 575w	6.25" Half Hat
Source 4 PAR MFL - 575w	Wybron Forerunner Color Scroller
	Template Holder
	Source 4 Drop In Iris
	Source 4 Handle
	7.5" 4 Panel Barn Door
	10" 4 Panel Barn Door

SL TORM

HANG CARD & NOTES

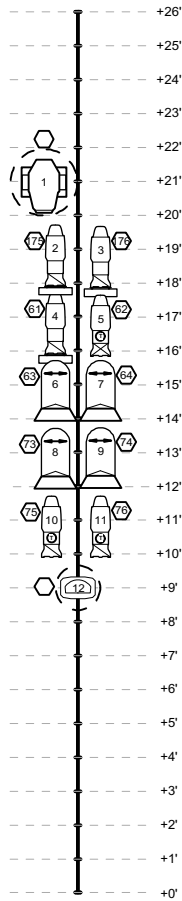

SL TORM

NOTES:

- Frost/Diffusion for color is a separate column in lightwright.
- Circuits come from the pit (73-76, 61-64) and from L 1/8 (175-176) which is on LX 1.
- 4-pin DMX comes from the SL Gallery scroller power supply.
- DMX comes from the SL Gallery opto splitter Line 2.
- See lightwright for addressing.
- 208v power comes from SR Gallery Soca Line A2
- All units to be on side arms.
- Scrollers are already addressed and labeled. Please use the correct one from show box.
- Please see ME before hanging Robe Robin DLS - it will be hung with special rigging.
- Don't forget the barndoors!

CONVENTIONALS:	MOVING LIGHTS:
Source 4 19 deg - 575w	Robe Robin DLS
Source 4 26 deg - 575w	Martin MAC Aura
Source 4 36 deg - 575w	Martin MAC 301
Source 4 50 deg - 575w	Martin MAC 301
Source 4 19 deg - 750w	Martin MAC 301
Source 4 10 deg - 750w	Martin MAC 301
Source 4 5 deg - 750w	Martin MAC 301
PAR 64 WFL - 1kw	6.25" Top Hat
8" Fresnel - 1kw	6.25" Half Hat
Source 4 PAR WFL - 575w	Wybron Forerunner Color Scroller
Source 4 PAR MFL - 575w	Template Holder
	Source 4 Drop In Iris
	Source 4 Handle
	7.5" 4 Panel Barn Door
	10" 4 Panel Barn Door

SR TORM

HANG CARD & NOTES

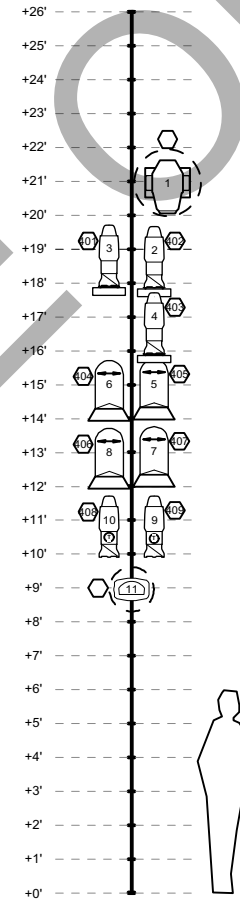

SR TORM

NOTES:

- Frost/Diffusion for color is a separate column in lightwright.
- Circuits come from Soca A (401-406) and Soca B (407-409).
- Soca B needs to split on rail as the other 4-6 run elsewhere.
- 4-pin DMX comes from the SR Gallery scroller power supply.
- DMX comes from the SR Gallery opto splitter Line 2.
- See lightwright for addressing.
- 208v power comes from SR Gallery Soca Line A1
- All units to be on side arms.
- Scrollers are already addressed and labeled in show box.
- Please see ME before hanging Robe Robin DLS
- Don't forget the barndoors!
- When finish run spare circuit 49 up from pit.

CONVENTIONALS:	MOVING LIGHTS:
Source 4 19 deg - 575w	Robe Robin DLS
Source 4 26 deg - 575w	Martin MAC Aura
Source 4 36 deg - 575w	Martin MAC 301
Source 4 50 deg - 575w	Martin MAC 301
Source 4 19 deg - 750w	Martin MAC 301
Source 4 10 deg - 750w	Martin MAC 301
Source 4 5 deg - 750w	Martin MAC 301
PAR 64 WFL - 1kw	6.25" Top Hat
8" Fresnel - 1kw	6.25" Half Hat
Source 4 PAR WFL - 575w	Wybron Forerunner Color Scroller
Source 4 PAR MFL - 575w	Template Holder
	Source 4 Drop In Iris
	Source 4 Handle
	7.5" 4 Panel Barn Door
	10" 4 Panel Barn Door

COUNTERS

LED INSTALL & NOTES

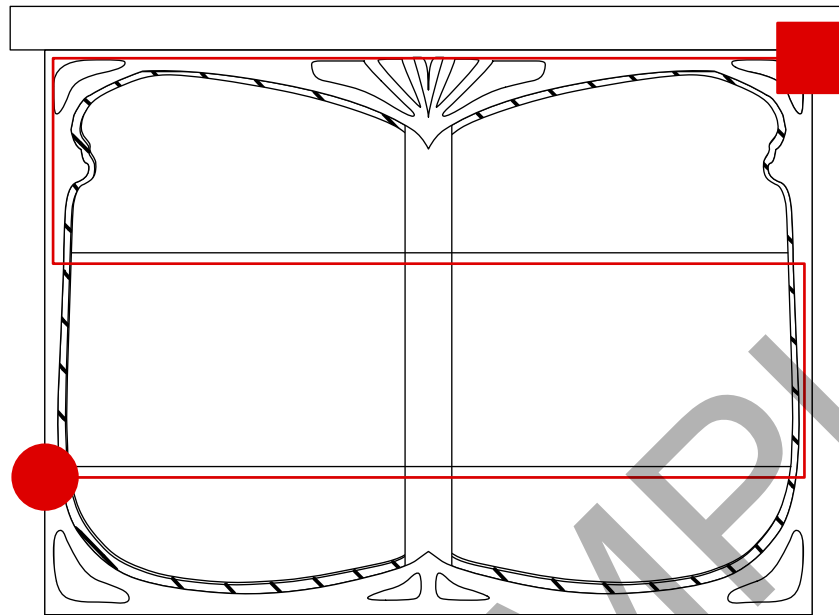

Start (RC4 Unit)

End



Only 2 links of LED tape on the US/DS edge of shelf.

NOTES:

- Counters will be wireless and the bottom row of LED tape will connect to the RC4 unit.
- Please use Marine Cycle Car Battery (x2), and the 30 Ah 12v Battery (x1) from stock.
- SL Counter should be the Ah 12v Battery
- LED Tape should top light the shelf below it (see diagram - attaches to the bottom of the shelf).
- All ethernet connections should be hidden in false back
- Please see ME for hookup to battery & RC4 unit
- Build 3

LED Tape Detail:

Type: SMD 2835
Qyantity of LED: 600 LEDS per roll.
Voltage: DC12v
Wattage: 60w per roll
Length: 16.4' per rool
Plate Width: 8mm
Color Temp: Cool White

WINDOW WALL

LED INSTALL & NOTES

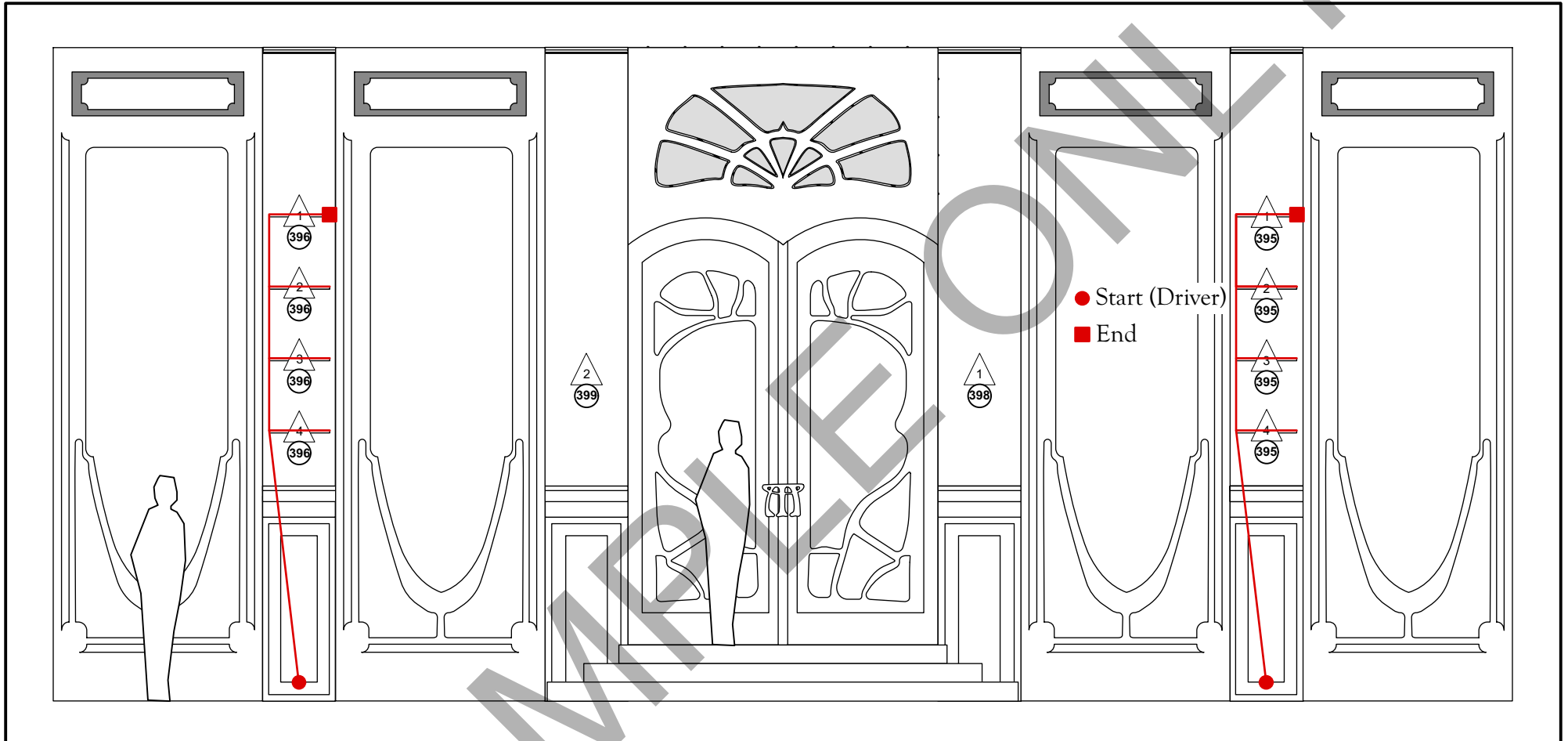

NOTES:

- DMX comes from the Opto Splitter on the dimmer rack Line 2
- 120v power comes from the distro Line 6
- LED Tape should uplight items on the shelf (see diagram - attaches to the top of the shelf).
- All ethernet connections should be hidden behind wall.
- Wall sconce circuits come from USL & USR floor pocket.

LED Tape Detail:
 Type: SMD 2835
 Quantity of LED: 600 LEDs per roll.
 Voltage: DC12v
 Wattage: 60w per roll
 Length: 16.4' per roll
 Plate Width: 8mm
 Color Temp: Cool White

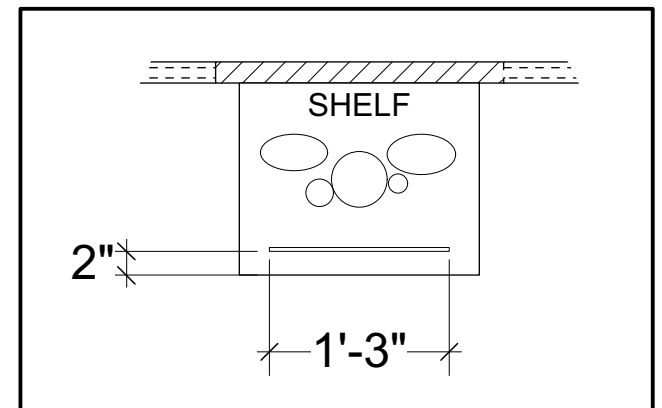

LIGHT BRIDGE				
UNIT	UNIT WEIGHT	x	TOTAL UNITS	TOTAL WEIGHT
Source 4 LEKO	20		26	520
Top Hats	2		10	20
CABLE	5		26	130
TOTAL ELECTRIC WEIGHT				670
				/40
BRICKS NEEDED				16.75
				16.75

LX 1				
UNIT	UNIT WEIGHT	x	TOTAL UNITS	TOTAL WEIGHT
PAR 64	12		10	120
MAC AURA	13		3	39
CABLE	5		13	65
TOTAL ELECTRIC WEIGHT				224
				/40
BRICKS NEEDED				11.2
				*2
				11.2

LX 2A				
UNIT	UNIT WEIGHT	x	TOTAL UNITS	TOTAL WEIGHT
Source 4 LEKO	20		8	160
8 BOX	45		1	45
CABLE	5		8	40
TOTAL ELECTRIC WEIGHT				245
				/40
BRICKS NEEDED				12.25
				*2
				12.25

LX 2B				
UNIT	UNIT WEIGHT	x	TOTAL UNITS	TOTAL WEIGHT
Source 4 LEKO	20		10	200
PAR 64	12		8	96
MAC Aura	13		3	39
10" Barndoors	4		4	16
4 BOX	20		1	20
8 BOX	45		1	45
CABLE	5		21	105
TOTAL ELECTRIC WEIGHT				521
				/40
BRICKS NEEDED				26.05
				*2
				26.05

LX 3A

She Loves Me

Electrics Run Sheet

Complete Time	Page #	Who	Action	Location	With/Notes
Preshow					
		Naomie	Turn on Company Power	SR	
		Omri	Remove Ghostlight	Onstage	
		Spot Operators	Warm Up Spots & Practice	Spot Booth	
		Naomie & Omri	Place Batteries	Onstage/SR	Counters/Bedroom - Small to Bedroom/Large Batteries to Counter
		Naomie & Omri	Channel Check		
Act I					
Scene 3					
7:10	60	Blas	Swap S4 Par Boom Gels to Blue (R68)	SL	Only Booms 1-3
7:10	60			SR	Only Booms 1-3
Intermission					
9:25 (29:25)	79	Blas	Swap S4 Par Boom Gels to Fushia (L328)	SL	Only Booms 1-3
9:25 (29:25)	79			SR	Only Booms 1-3
9:25 (29:25)	79	Sharim	Move/Unplug SL Rover	DSL	
9:25 (29:25)	79	Naomie	Swap RC4 from Counter to Bedroom	Onstage/SR	SR Counter; TEST IT!
Act II					
Scene 1 to Scene 2 Transition					
	88	Jamie	Move to Spike Replug SL Rover	DSL	
	88	Naomie (or deck crew)	Move/Unplug SR Rover	DSR	
Scene 2 to Scene 3 Transition					
2:30	100	Jaime	Move to Spike Replug SR Rover	DSR	

She Loves Me

Complete Time	Page #	Who	Action	Location	With/Notes
2:30	102	Naomie	Swap RC4 from Bedroom to Counter	Onstage/SR	SR Counter; TEST IT!
Postshow					
		Spot Operators	Turn Off Spots & Sights	SR	
		Naomie & Omri	Place Batteries on Chargers	Patch Room	Counters/Bedroom
		Omri	Put out ghostlight	Onstage	
		Naomie	Turn off Company Power	SR	

EXAMPLE